

2017 Newport Harbor High School Field Show Competition

October 14, 2017

***** NEWPORT HARBOR HIGH SCHOOL *****
600 Irvine Avenue, Newport Beach, CA 92663

www.nhhsmusic.com

Welcome to the 10th Annual Newport Open!

Please take a moment to read through the following information. If you have any further questions, please contact us directly or on event day, your assigned NHHS student ambassadors can get you the answers quickly.

In case of (non 911) emergencies on Newport Open day, please call

Newport Open Band Director Rob Henthorn, cell: 949.922.7839,

John Patterson cell: 714.269.0049 or Joe Tortorello cell: 714.747.9661

1. PARKING

Premium guest/spectator parking is available in the General student lot located off of 16th street adjacent to the main entrance to the stadium. Additional parking is available on the street outside of the stadium.

Band bus and trailer parking is located off 15th street on the South side of the school. Staff will be on hand to provide direction. Look for the signs indicating Bus Parking. Check-In will be at the entrance to the parking lot.

Handicapped parking is available in designated spots in the lots listed above; also by following directions from event parking staff.

2. UPON ARRIVAL

A representative from our Registration tent will meet you at your bus shortly after parking. Immediately upon arrival please check the schedule included in your packet for any updates on performance times. In the packet you will find:

- One Director's Badge, which will serve as your admission to the VIP Lounge
- Orange wristbands for staff and coaches which will also grant access to the VIP Lounge
- White wristbands for students - ALL students need to have a wristband on in order to enter the campus and re-enter the stadium.
- Splatter wristbands for parent helpers/chaperones. We have included 1 parent wristband per every 10 students in your band. If you find you need

additional wristbands, please plan on purchasing those at the Check-In tent. ALL parent helpers/chaperones must have a wristband on in order to enter the stadium for competitions PRIOR to arriving at the band or pit gates. There will be no exceptions.

WE WILL BE OFFERING ADDITIONAL CHAPERONE WRISTBANDS ABOVE AND BEYOND THE 1:10 THAT IS PROVIDED COMPLIMENTARY AT A 30% DISCOUNT IF PURCHASED IN ADVANCE. WRISTBANDS MAY BE PURCHASED THROUGH THE ONLINE STORE AT SHOP.NHHSMUSIC.COM DURING REGISTRATION OR SEPARATELY UP TO 1 WEEK PRIOR TO THE EVENT. TO ORDER AFTER REGISTRATION SELECT THE ADULT WRISTBAND AND USE COUPON CODE NHHS2016 AT CHECKOUT TO RECEIVE THE DISCOUNT.

ALL ATTENDEES MUST WEAR WRISTBANDS AT ALL TIMES.

Only adults with a Director's badge or orange wristbands will be allowed into the VIP Lounge. We have found this to be a good place to visit with friends, take in some great food and keep an eye on the students and the tournament. Please visit and enjoy!!

3. ADMISSION

General admission: \$ 10.00

Active Military (with valid I.D.): \$ 7.00

Children under 6 yrs. free

4. RESTROOMS

Restrooms are clearly marked and available near the warm up areas and in the stadium. Uniform changing may be done in your buses. Please DO NOT allow your students to use the restrooms for changing in or out of their uniforms.

5. WARM UP AREAS

There are 3 areas designated for band warm up. These areas are marked as A, B and C on your map. Your assigned NHHS student ambassadors will assist you in locating that area. Your 30 minute warm up time is specified on the schedule and time will begin 45 min prior to your performance. We will not be enforcing for you to be at the staging gate a full 10 minutes prior to your performance, however, any group responsible for delaying the competition will receive the maximum timing penalty assessed to your final score. It is your responsibility to arrive on time.

Pit sections can use the bus parking lot for warm-up. ONLY PITS MAY PLAY IN THE BUS PARKING LOT!!

Auxiliary units may use any portion of the athletic fields for their warm-up. These are in close proximity to the stadium. If you use a broadcast metronome (i.e.: Dr. Beat) it cannot interfere with the performances in the stadium so please plan accordingly and be courteous.

6. GROUP ESCORTS

Each band will be assigned 1 or 2 student ambassadors who will remain with the group until after returning to the stadium following your competition. They will answer any questions you might have on the day of the performance as well as help to keep a line of communication open between you and our staff. It is your responsibility to keep your eye on the time.

7. FIRST AID

There will be a First Aid tent/Info Booth on the entry side of the spectator grandstand. It is for minor emergencies or health problems. Major health issues will be handled through our local Paramedics.

8. SECURITY

All NHHS parent volunteers/band boosters are easily identifiable in navy blue NHHS t-shirts and for Area Leads and Security staff, a NHHS neon safety vest. Any issues or concerns should be directed to any of our adult volunteers. Everyone's SAFETY is our top priority.

9. FOOD AND BEVERAGES AT OUR FOOD COURT

We do not allow preparation of food on any Newport-Mesa Unified School campus per school district policy and will be enforced on competition day.

A selection of delicious, fresh, warm entrees such as burgers, pizza, burritos and hot dogs will be available a la carte. Beverages such as water, a large variety of sodas, coffee, tea and hot chocolate are available at the Concessions stand along with candy of all kinds, fresh popped corn, nachos and chips.

10. JUDGING

Judges are supplied by the CSBC.

11. BAND / PIT CARTS / PROPS ASSISTANCE ENTRY

➤ BANDS

- Bands will travel East along Irvine avenue up to the large gate and enter the stadium through this gate just behind the scoreboard.
- Once advised move into position just behind the West goal posts to the field. Please arrive at your designated time in order to be able to be in position.
- BAND will exit the field to the track towards the VISITOR side and exit through the gate at the North side of the track. This is a smaller gate so there may be a bit of a bottleneck for larger bands so please be sure to get the band off of the field and onto the track in the allotted time. The band will exit the stadium through the VISITOR side gate and follow the pathway back to the buses.

➤ PROPS

- Drop any large field props in designated area at the West side of s
- Once advised you may move to the waiting area on track (West

- end of the field) 10 minutes before performance time.
 - When the previous bands' performance is finished, proceed forward and unload equipment.
- PIT
 - Stage in the area just inside of the black gate and to the West side just behind the tennis courts but before the large gate to the track (please follow and pay close attention to prompts from our security staff).
 - Move to the waiting area on track (West end of the field) 10 minutes before performance time.
 - PIT will exit through the gate just in front of the pit waiting area and exit the stadium through the same black gate you entered through.
- Only motorized vehicles with pneumatic wheel will be allowed on the track.

12. ELECTRICAL POWER

Electrical power is available at the field level on the front of the field near the "50". If we blow a fuse, it is the competitor's responsibility to have a back-up source of electrical power.

13. PERFORMER RE-ENTRY AND SEATING

Performers may re-enter the stadium after their performance through the VISITOR GATE which is the same gate where the bands will exit. All students with white wristbands and parents/chaperones with splatter wristbands may sit in the main grandstand areas designated for bands. As the stadium fills up later in the day and as space permits larger bands may be directed to the visitor side for seating.

14. PERUSAL PERIOD

The 5-minute perusal period will take place during the awards ceremony. At this time, you may check for mathematical errors on the score sheets and recaps. You may then approach the head judge about speaking with an adjudicator.

Thank you and Good Luck!

Rob Henthorn
NHHS Music Director

and





NEWPORT-MESA UNIFIED SCHOOL DISTRICT

DAVIDSON FIELD STADIUM USE RULES

The field is a synthetic surface (Field Turf) and the track is an Atlas synthetic surface.

Both of these products require the following rules to assure the stadium remains in a safe and operational condition.

- **NO PETS**
- **NO PAINTING ON FIELD OR TRACK SURFACE**
- **NO ANCHORING DEVICES (STAKES) USED ON FIELD OR TRACK SURFACE**
- **NO SUNFLOWER SEEDS OR GUM**
- **NO FOOD, SPORTS DRINKS OR FRUIT (WATER ONLY)**
- **NO GLASS BOTTLES OR CONTAINERS**
- **NO TOBACCO PRODUCTS, FIREWORKS, OR OPEN FLAME**
- **NO BICYCLES, SKATEBOARDS, SCOOTERS, IN-LINE SKATES OR VEHICLES (INCLUDING SCISSOR LIFTS)**
- **NO ONE UNDER THE AGE OF 18 ALLOWED ON SIDELINES UNLESS DIRECTLY INVOLVED IN THE EVENT**
- **DO NOT USE ANY TAPE OR ADHESIVE MATERIAL ON FIELD OR TRACK**
- **NEUMATIC/AIR FILLED WHEELS ONLY ALLOWED ON TRACK AND TURF FIELD**

You must restrict your sidelines (for coaches, players, and support personnel only) and make sure all individuals on the sidelines follow the above guidelines at all times.

2017 Newport Beach Open Field Competition

SITE MAP

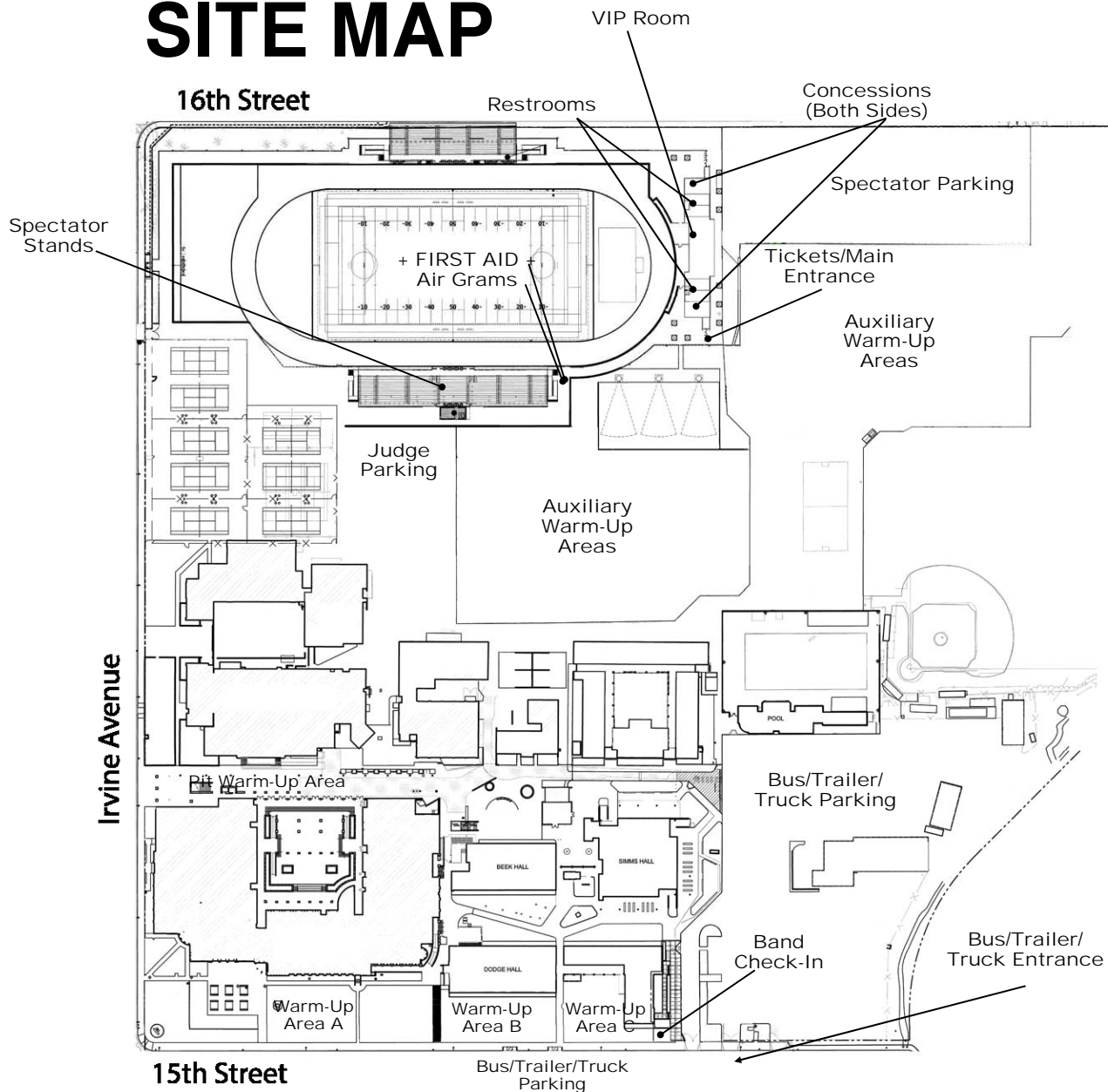

OCTOBER 14, 2017
NEWPORT BEACH HIGH SCHOOL
600 IRVINE AVE., NEWPORT BEACH, CA 92663
DAVIDSON FIELD

2017 Newport Beach Open Field Competition BAND MAP

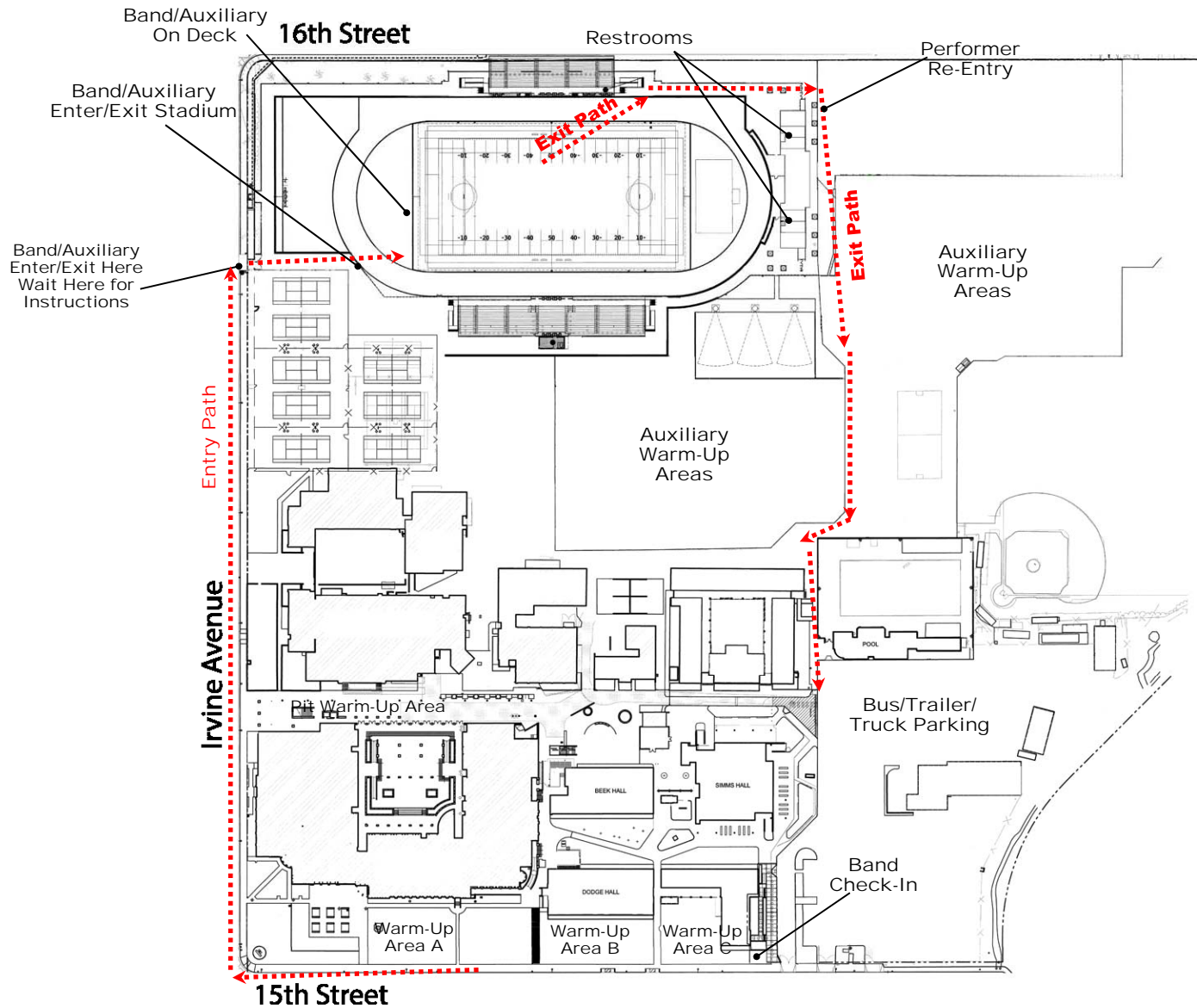

OCTOBER 14, 2017
NEWPORT BEACH HIGH SCHOOL
600 IRVINE AVE., NEWPORT BEACH, CA 92663
DAVIDSON FIELD

2017 Newport Beach Open Field Competition

AUXILIARY MAP

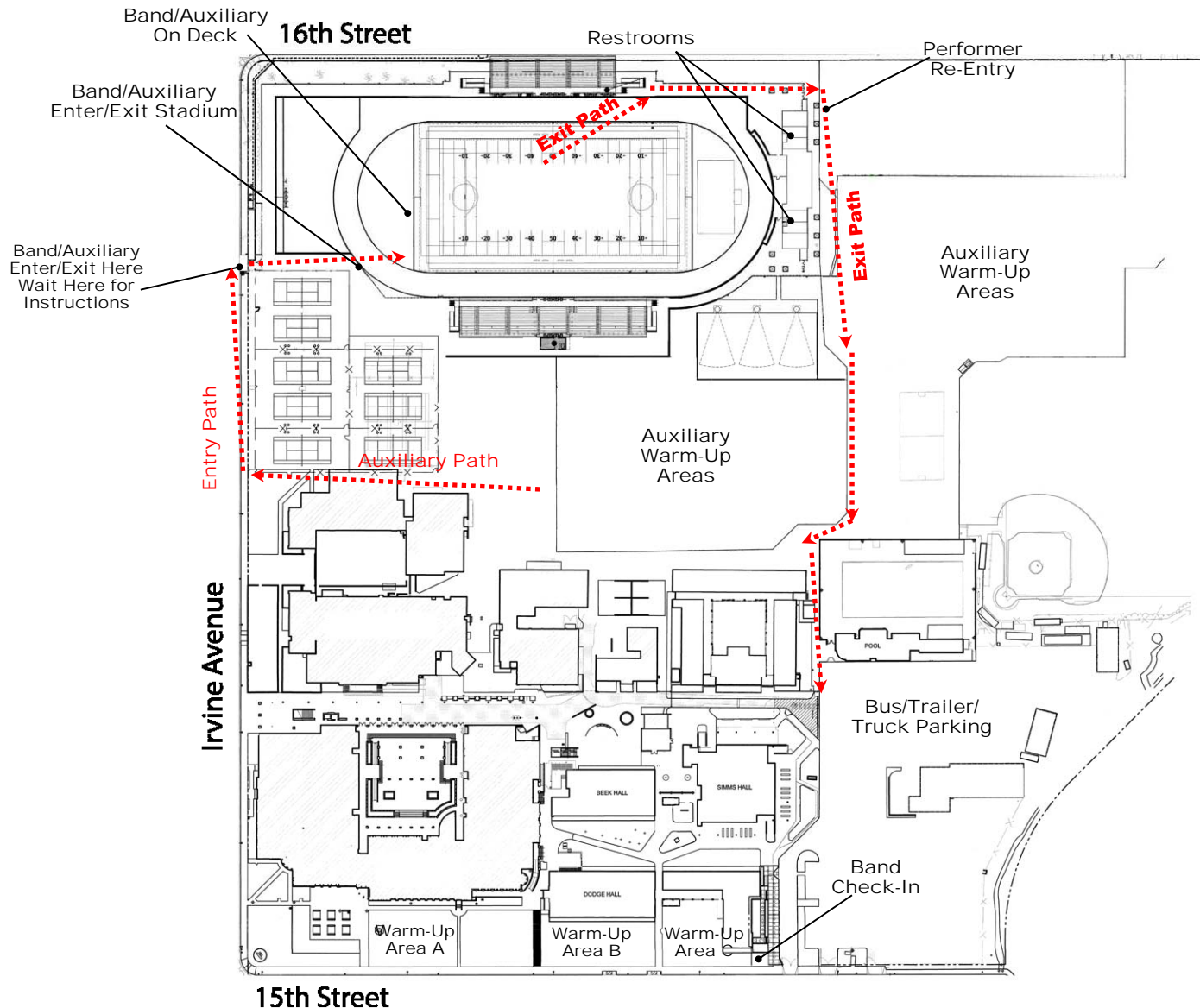

OCTOBER 14, 2017
NEWPORT BEACH HIGH SCHOOL
600 IRVINE AVE., NEWPORT BEACH, CA 92663
DAVIDSON FIELD

2017 Newport Beach Open Field Competition PIT MAP

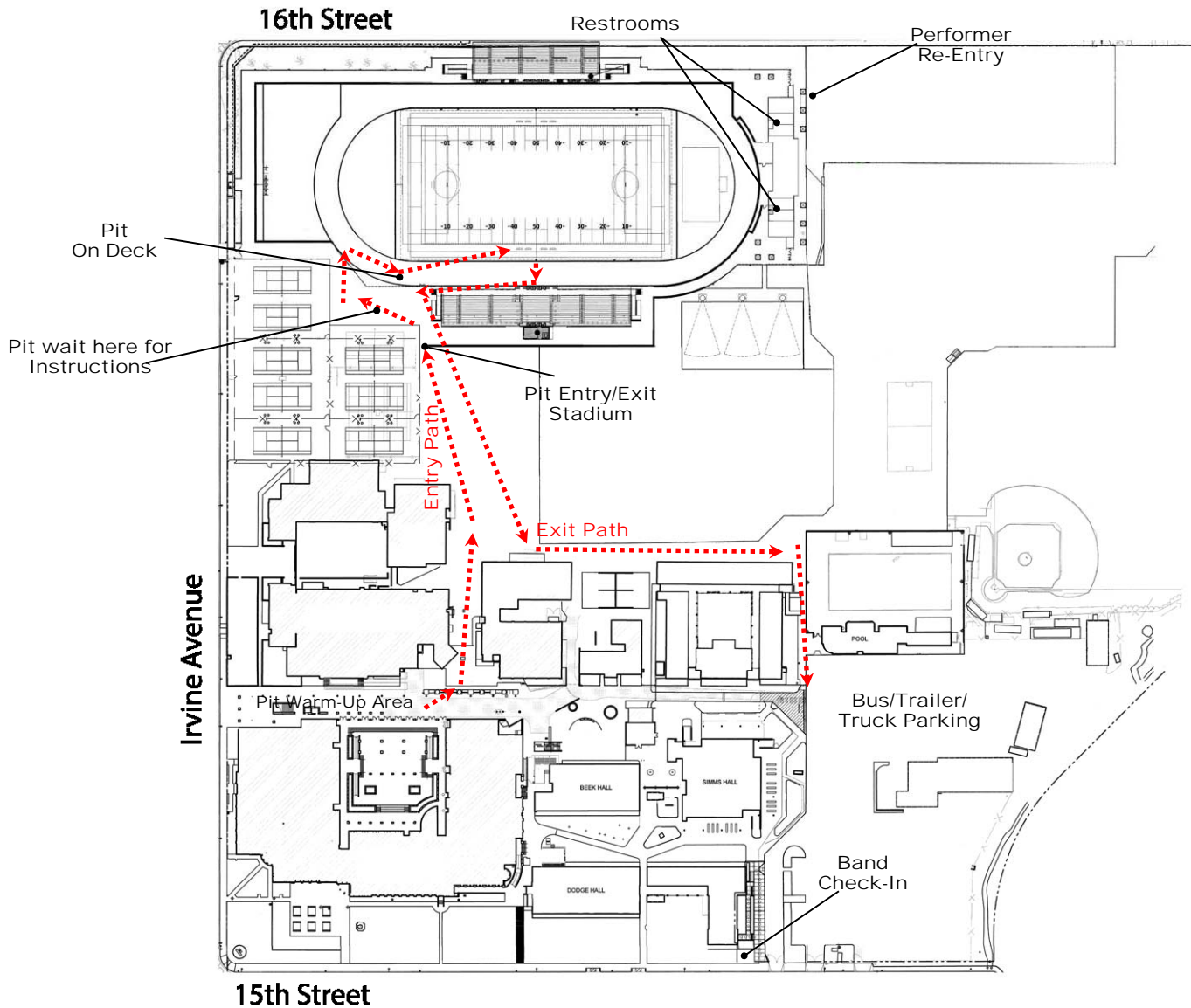

OCTOBER 14, 2017
NEWPORT BEACH HIGH SCHOOL
600 IRVINE AVE., NEWPORT BEACH, CA 92663
DAVIDSON FIELD