

**2019 TCGC Akins HS Percussion Information**  
**Saturday, March 2**  
**Show Start Time: 8:00PM**

**Facility**           Akins HS  
                          10701 S 1st St,  
                          Austin, TX 78748

**Ticket Prices:** \$10  
Cash or credit, booster organizations can make checks payable to

Please contact the show sponsor PRIOR to the show if you have any questions or have a special circumstance.

**Contest Director**

Jessica Mendez  
[westcd@texascolorguardcircuit.org](mailto:westcd@texascolorguardcircuit.org)

**Show Host Contact**

Daniel Sharp  
512-308-2666  
[danielsharp99@gmail.com](mailto:danielsharp99@gmail.com)

**Judging Panels**

**Color Guard**

Music	Peter Furnari
Effect Mus	Jon Merritt
Effect Vis	Jon Duke
Visual	Gary Graves

**TO LISTEN TO JUDGES**

**COMMENTARY:**

Each director should be set up with an account through CompetitionSuite. This is the ONLY WAY to receive judge's commentary for any TCGC event.

**SOUND TESTING:**

One hour prior to the start of the contest and during breaks at the discretion of the contest director. Music should be uploaded to CompetitionSuite.

**WARM-UP AREA:**

All maps are in this packet.

**RECAPS:** Recaps will be available through CompetitionSuite only

**CRITIQUE:** Signup through CompetitionSuite only.

**VIDEO TAPING:**

No video cameras allowed and no authorized video space will be provided. TCGC does not condone nor accept liability for any unauthorized recording during an event.

Don't forget to review the [Keys to a Successful Contest Day!](#)



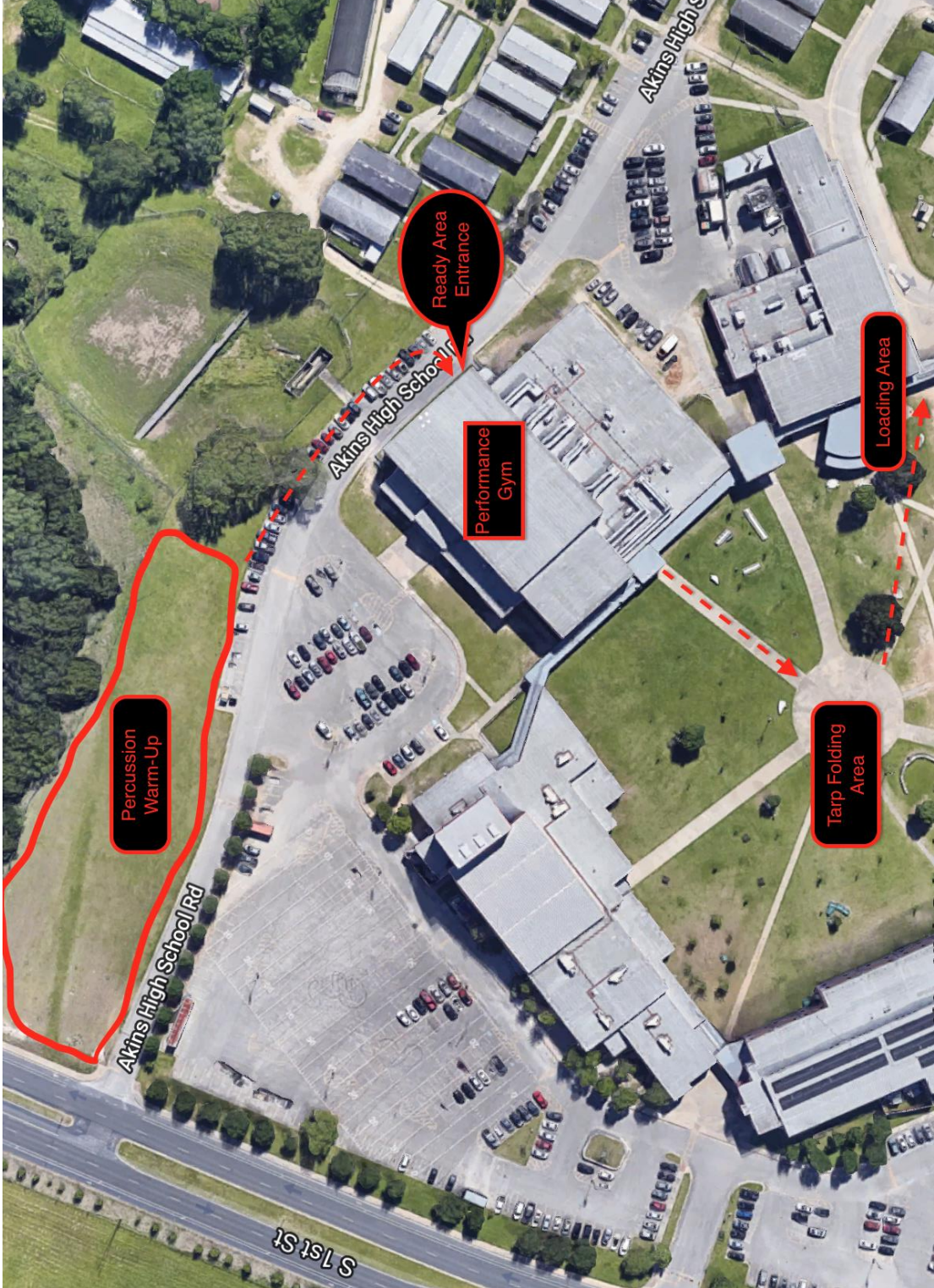



*Athletic Ridge*

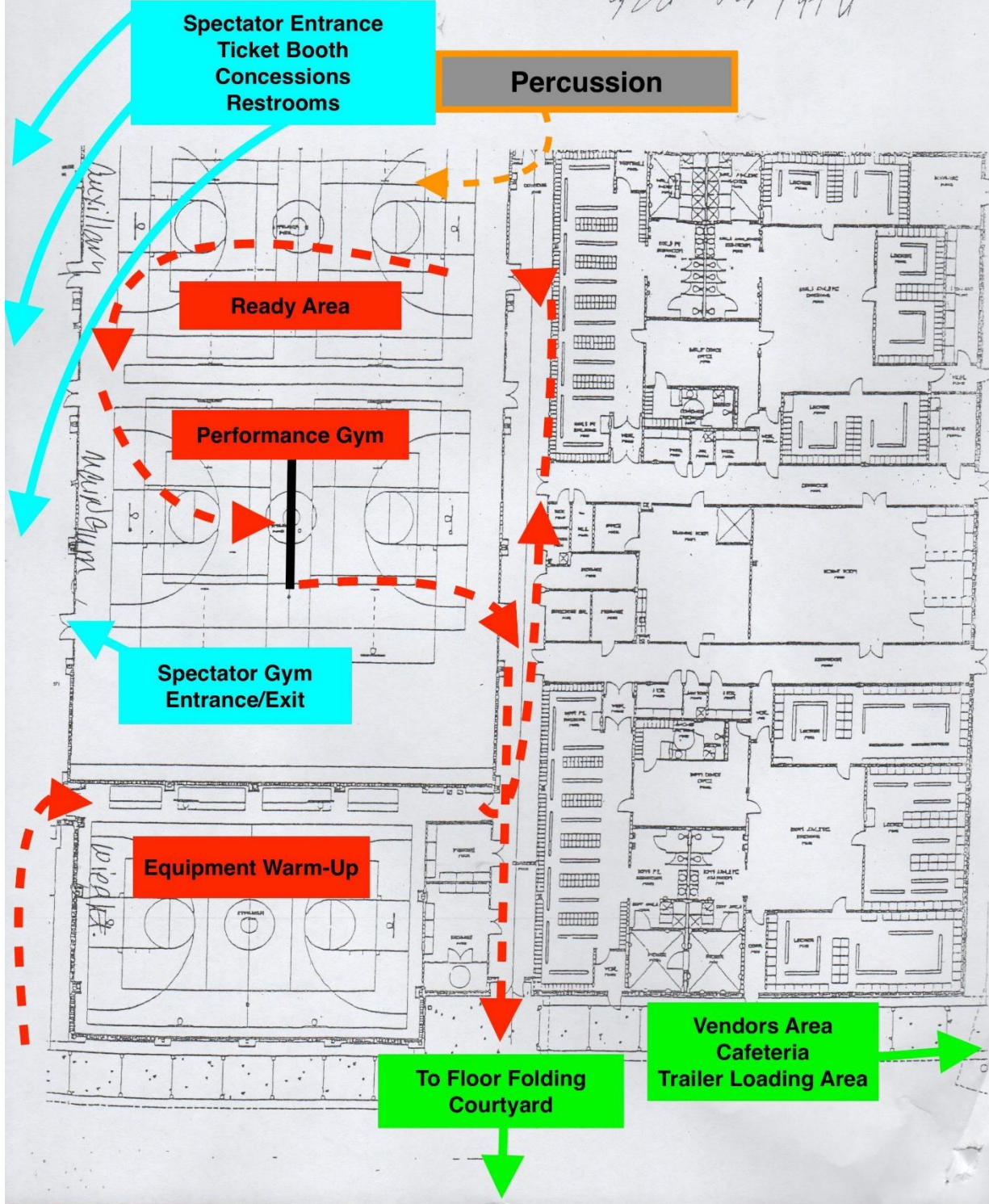



## Akins HS Perc

### Competition Area

All TCGC contest sites must have a minimum of seventy by one hundred feet (70' x 100') to accommodate a "safety zone" of five (5) feet from any spectator seating. If no spectators are seated on the left and right sides, then the safety zone will be eliminated on the left and right sides of the competition area and can extend to a maximum of 100' x 70'.

The "competition area" at this event measures 95' x 70'. All performing groups must be prepared to perform within that area. Floors (tarps) may not extend into safety zones per rules found in the WGI Adjudication Manual and Rulebook.

