

**2020 TCGC AREA South Championships
Pearland High School Information
Saturday, March 14
Show Start Time: 10:00AM**

Facility Pearland HS
3775 S Main St,
Pearland, TX 77581

Ticket Prices: \$15
Cash or credit, booster organizations can make checks payable to

Please contact the show sponsor PRIOR to the show if you have any questions or have a special circumstance.

Contest Director

Rachel Trevino
512-262-6117
northcd@texascolorguardcircuit.org

Show Host Contact

Kim Condit
346- 219-4591

Judging Panel

Color Guard

EQ	Sue Nicholson
MV	Curtis Uhlemann
DA	Brent Rowland
GE	Jackie Gilley (Lead Judge)
GE	Taylor Sitzman

RETREAT: NO HELIUM BALLONS, CONFETTI, BUBBLES. We must take care of the tarp/court.

TO LISTEN TO JUDGES

COMMENTARY:

Each director should be set up with an account through CompetitionSuite. This is the **ONLY WAY** to receive judge's commentary for any TCGC event.

SOUND TESTING:

One hour prior to the start of the contest and during breaks at the discretion of the contest director. Music should be uploaded to CompetitionSuite.

WARM-UP AREA:

All maps are in this packet. Color guards should report one hour prior to performance time. The Show Host will provide sound equipment with auxiliary cords for MP3 or iPod use in both Warm-Up areas.

RECAPS: Recaps will be available through CompetitionSuite only

CRITIQUE: There is not critique for this event.

VIDEO TAPING:

No video cameras allowed and no authorized video space will be provided. TCGC does not condone nor accept liability for any unauthorized recording during an event.

Don't forget to review the [Keys to a Successful Contest Day!](#)



Unit Badges

- Each unit registered in TCGC will receive two (2) Unit Badges.
 - Additional Unit Badges are \$50 each.
- Unit Badges will be issued to members listed on the TCGC Unit Badge Application only (found in CompetitionSuite under Resources).
- Up to 2 staff members can be listed per application.
- Any additional Unit Badges your unit purchases must be accompanied by additional applications.
- Unit Badges will be personalized with the approved staff members name. Only that individual is authorized to use that badge.
 - Unit staff members found in violation of this policy will have their badges revoked for the remainder of the season and disciplinary action will be taken against the unit according to the TCGC Code of Conduct.

Flo Marching (*Present at this contest*)

FloSports will be the sole owner of the **Program(s)** and other material recorded by **FloSports** in connection with the **Program(s)**, including exclusive ownership of all copyrights in the **Program(s)**.

a. **TCGC** grants **FloSports** the right to reproduce and disseminate in any medium, the name, likeness and voice of each person appearing in or connected with the **Program(s)** as well as **TCGC** names and trademarks and those of any other entity associated with the **Event(s)** and the **Venue** for all reasonable purposes connected with **FloSports**' exploitation of the **Program(s)**. Except as set forth in this section, **FloSports** will not use any of the foregoing as a direct endorsement of any product or other services.

Site Information

Front Side Bleacher Rows: 19

Seating Capacity: 1026 Approximate

- There are no permanent obstructions above the competition floor.
- Color guards do not enter the competition area directly from the outdoors.
- There is electrical power available at the front and back sideline.
- Units do not exit the competition area directly to the outdoors.
- The hallways will be utilized for prop storage prior to the competition.
- There will be a black vinyl tarp measuring appx 60' x 90' covering the wooden gym surface.
- No indoor space is available for floor folding.

General Warm Up: 60x100

Body Warm Up: Large dance room with mirrors

Music may be used in body warm up at moderate levels to be determined per the contest administrator.

Equipment Warm Up: Full size gym

Music may be used in equipment warm up at moderate levels to be determined per the contest administrator.



No Parking On Street
Towing Strictly Enforced

Spectator
Parking

Team
Unloading
Zone

Bus and Truck
Parking

Volunteer Parking
Only

Truck and Bus
Entrance
Only

Google earth

Imagery Date: 7/31/2015 29°32'21.81" N 95°16'07.04" W elev. 66 ft eye alt. 2992 ft

1989

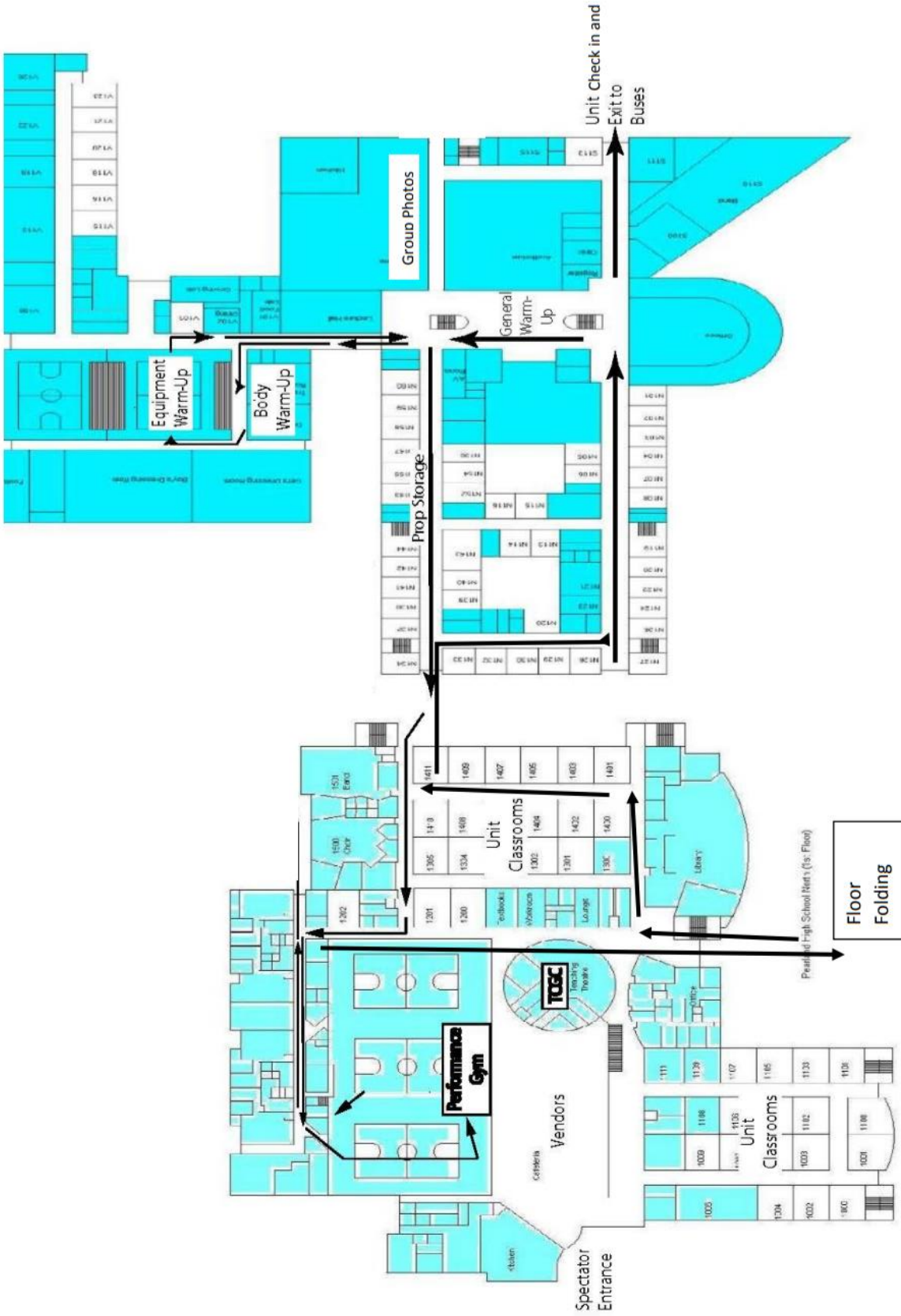

Floor Folding

Pearl of High School Reel's (1st Floor)

Spectator Entrance

Vendors

Performance Gym

T.O.C. Teaching Topics

Unit Classrooms

Unit Classrooms

Group Photos

Unit Check in and Exit to Buses

General Warm-Up

Equipment Warm-Up

Body Warm-Up

Prop Storage



Pearland HS CG

Competition Area

All TCGC contest sites must have a minimum of seventy by one hundred feet (70' x 100') to accommodate a "safety zone" of five (5) feet from any spectator seating. If no spectators are seated on the left and right sides, then the safety zone will be eliminated on the left and right sides of the competition area and can extend to a maximum of 108' x 70'.

The "competition area" at this event measures 95' x 65'. All performing groups must be prepared to perform within that area. Floors (tarps) may not extend into safety zones per rules found in the WGI Adjudication Manual and Rulebook.

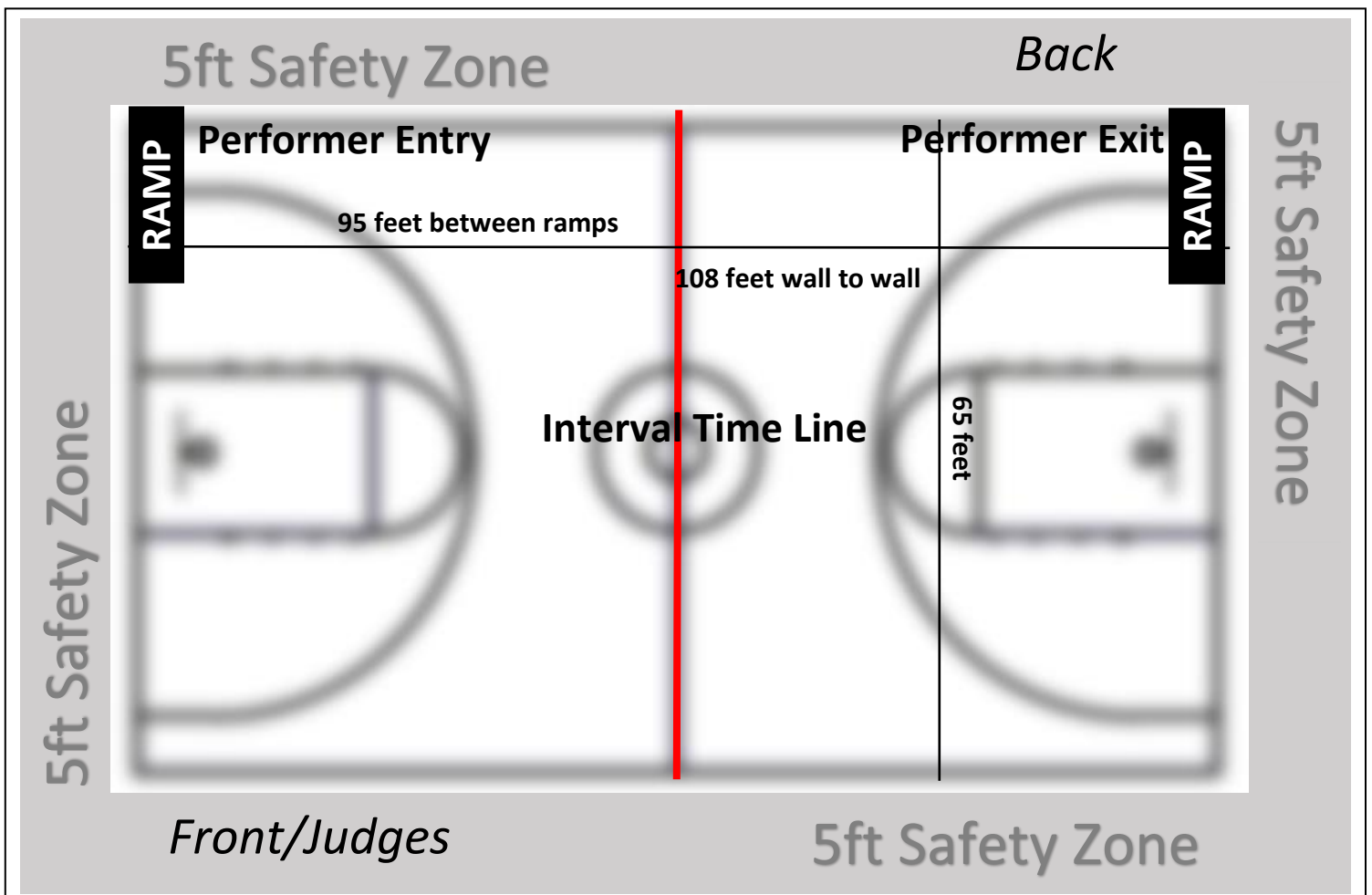

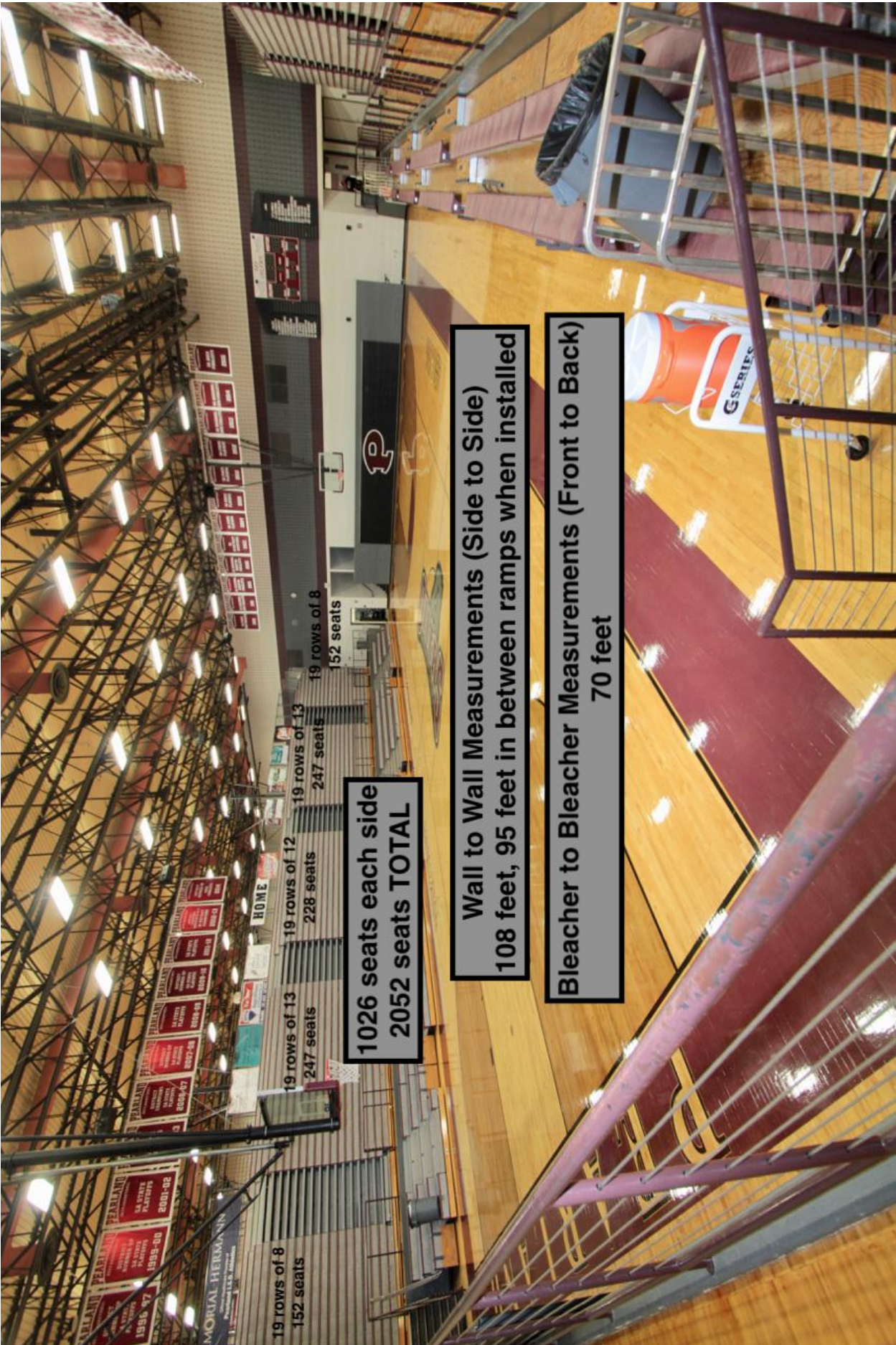

19 rows of 8
152 seats

19 rows of 13
247 seats

19 rows of 12
228 seats

19 rows of 13
247 seats

19 rows of 8
152 seats

**1026 seats each side
2052 seats TOTAL**

**Wall to Wall Measurements (Side to Side)
108 feet, 95 feet in between ramps when installed**

**Bleacher to Bleacher Measurements (Front to Back)
70 feet**

