

2023 TCGC Cypress Falls HS
Saturday, March 11, 2023
Start Time: 9:00 AM

Facility: Cypress Falls HS
9811 Huffmeister Road
Houston, TX 77095

Ticket Prices: \$10 (fees may apply)
Online Ticket Sales
(prior to & day of)

Show Contact Info:

Contest Director

Sara Bryant
eastcd@texascolorguardcircuit.org

Show Host Contact

Ryan Mohney
ryan.mohney@cfisd.net

Judging Panels:

Color Guard

EQ Jeffrey Capponi
MV Laura Aylsworth
DA Jen Barton
GE Mike Lopinto (LJ)
GE -Dennis Kerr

TO LISTEN TO JUDGES COMMENTARY:

Each director should be set up with an account through CompetitionSuite. This is the ONLY WAY to receive judge commentary for any TCGC event.

SOUND TESTING: One hour prior to the start of the contest and during breaks at the discretion of the contest director.

WARM-UP AREA: All maps are in this packet. Units should arrive/check-in at the time on the schedule. Please be prepared to provide your own sound equipment in the warm-up facilities.

RETREAT: There will be captain's only retreat(s) throughout the day as notated on the schedule.

CRITIQUE: There will be critique held the day after the event. Limited spots are available, but you must sign-up prior to day of show. There will be emailed information regarding critique sign-up.

VIDEO TAPING: TCGC will do everything possible to provide a video of each performance.

We appreciate your flexibility with the ever-changing world we live in today. We will be in close communication with the show host, and all necessary parties prior to our events, and will do our best to communicate in a timely manner any changes in circumstances surrounding our events.



HWY 290

Huffmeister Road

Tuckerton Road

Bus Entrance

Bus Parking

Unit Check-In
Door #4

Spectator Entrance
Door #14

Door
#16

Spectator Parking

Equipment Truck
Parking



TCGC Color Guard

Bus (Only)
Parking

CYPRESS FALLS HIGH SCHOOL
9811 HUFFMEISTER
HOUSTON, TX 77095
281.856.1000

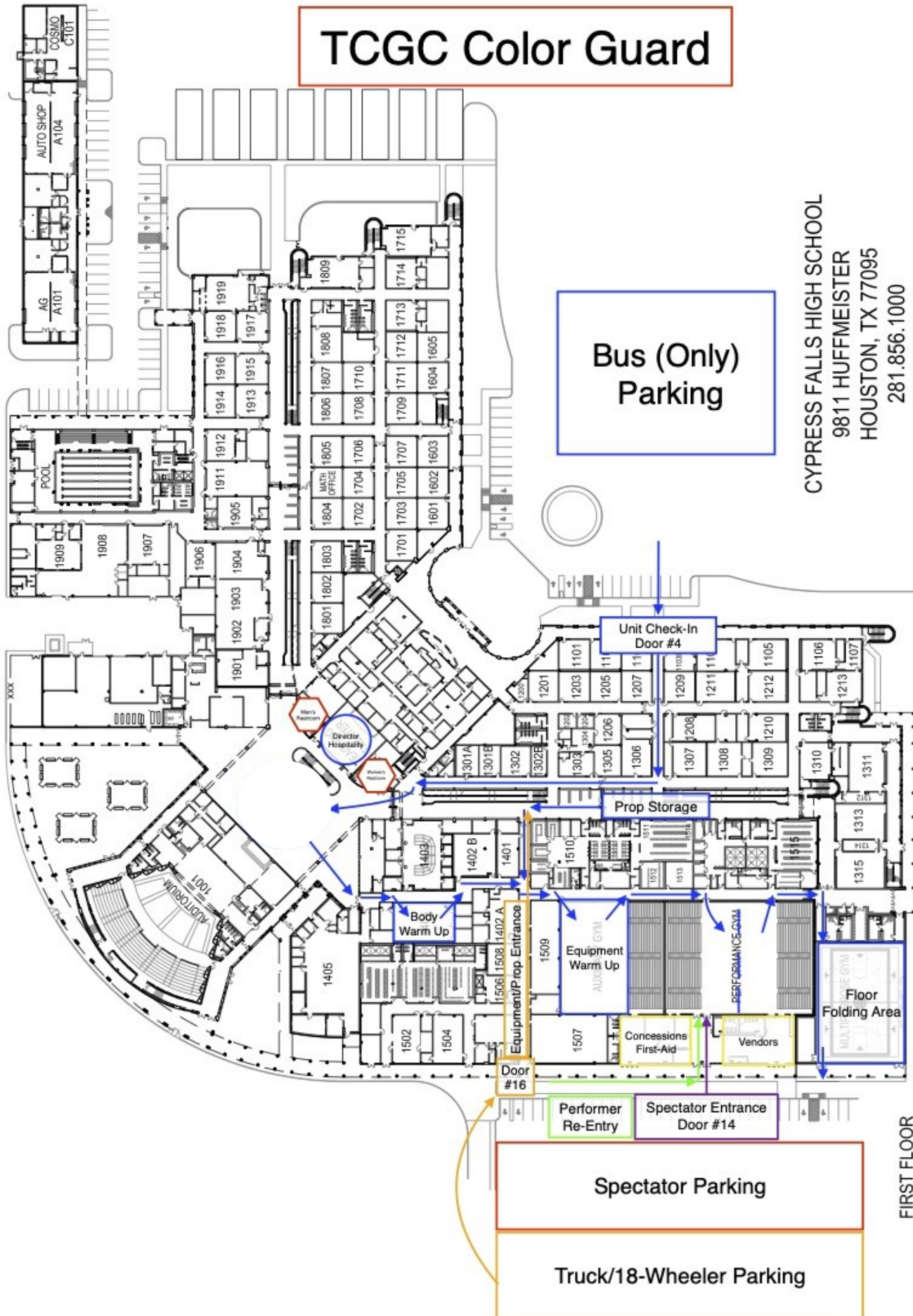

FIRST FLOOR



At TCGC events, we strive to provide a minimum of seventy by one hundred feet (70' X 100') to accommodate a "safety zone" of five (5) feet from any spectator seating. If no spectators are seated on the left and right sides, then the safety zone will be eliminated on the left and right sides of the competition area and can extend to a maximum of 106' X 78'.

The "competition area" at this event measures 102' X 60'. All performing groups must be prepared to perform within that area. Floors (tarps) may not extend into the safety zones per rules found in the WGI Adjudication Manual and Rulebook.

BACKSIDE SEATING

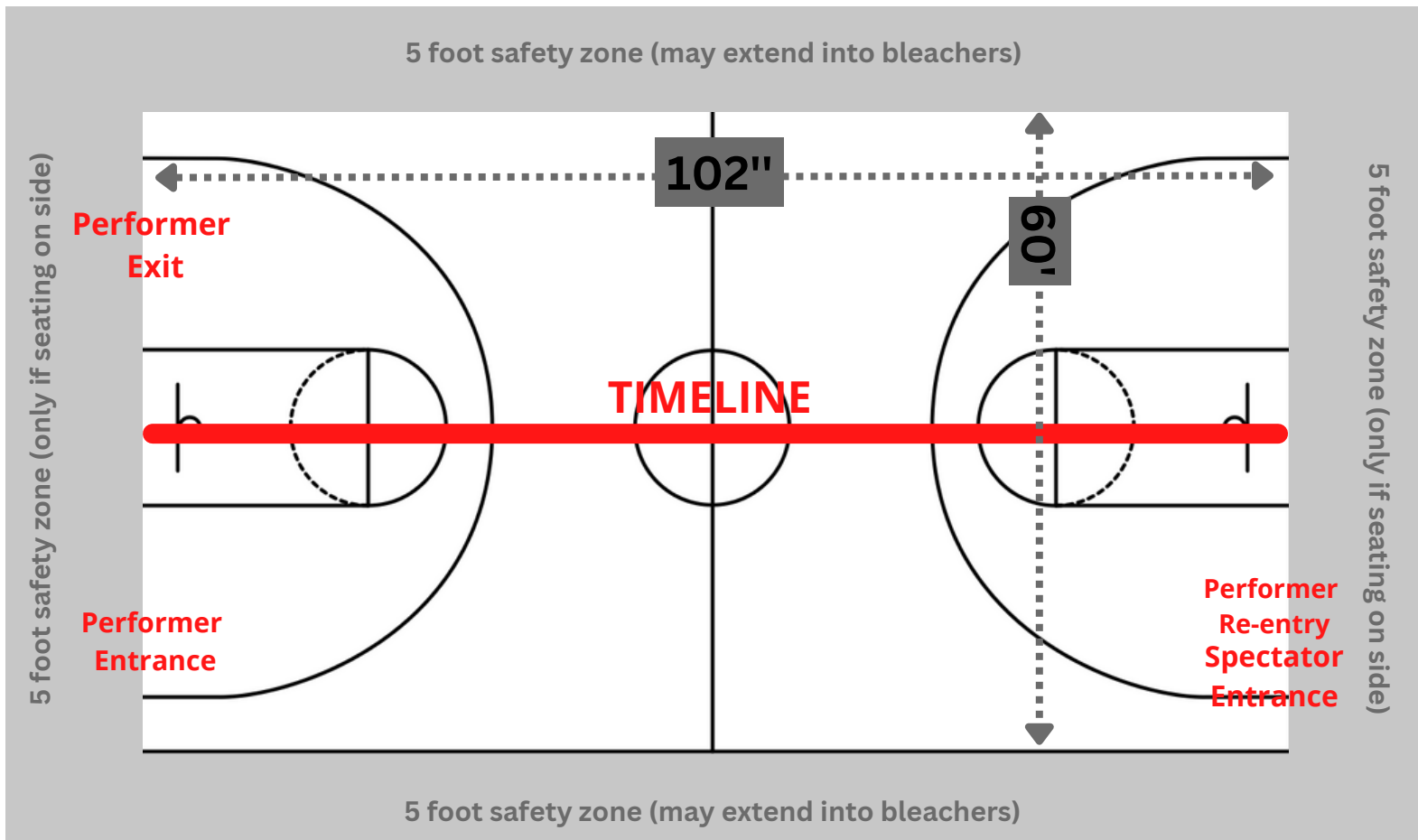

SPECTATOR SEATING

