

2022 TCGC Katy HS
Saturday, March 5
Start Time: 9:30 am

Facility: Katy High School
6331 Highway Blvd
Katy, TX 77494

Ticket Prices: \$10 (fees may apply)
Online Ticket Sales
Cash & Credit accepted on site

Show Contact Info:

Contest Director

Sara Bryant
eastcd@texascolorguardcircuit.org

Show Host Contact

Michelle Jordan
michellejordan717@yahoo.com

Judging Panels:

Color Guard

EQ Tabitha Sebastino
MV Jaycee Clarke-Bentely
DA Mike Hardy (LJ)
GE Jason Pliska
GE Mark Moreno

TO LISTEN TO JUDGES COMMENTARY:

Each director should be set up with an account through CompetitionSuite. This is the **ONLY WAY** to receive judge commentary for any TCGC event.

SOUND TESTING: One hour prior to the start of the contest and during breaks at the discretion of the contest director.

WARM-UP AREA: All maps are in this packet. Units should arrive/check-in at the time on the schedule. Please be prepared to provide your own sound equipment in the warm-up facilities.

RECAPS: Recaps will be available online within 24 hours of the end event.

RETREAT: There will be captain's only retreat(s) throughout the day as notated on the schedule.

VIDEO TAPING: TCGC will do everything possible to provide a video of each performance.

We appreciate your flexibility with the ever-changing world we live in today. We will be in close communication with the show host, and all necessary parties prior to our events, and will do our best to communicate in a timely manner any changes in circumstances surrounding our events.





KATY HIGH SCHOOL BAND

6331 HIGHWAY BLVD • KATY, TX • 77494

On behalf of the Katy Band Booster Association, welcome to Katy High School! We hope that you enjoy your visit on our campus today. If at any time you have a question, please ask one of our parent or student volunteers and we would be happy to assist you. You can always find volunteers at Unit Check-In.

Unit Check-In is located just inside the building from the circle drive where buses unload. Prop/Floor Unloading is just to the left of Unit Check-In.

Once unloaded, all buses and trucks must be parked in their appropriate lots (please see maps for directions).

Our first aid station provided by will be set up on the stage in the cafeteria all day for all your medical needs.

Our Concession Stand is located in the cafeteria and will open at 8:00am. It will be stocked all day with breakfast, lunch, dinner, and everything in between. Please see the attached Menu for pricing list. **NO OUTSIDE FOOD OR DRINK WILL BE ALLOWED TO ENTER THE BUILDING.** Because this is a large fundraising effort for our organization, we ask that you kindly respect this policy and plan your meals accordingly.

Located outside the Performance Gym, you will find a wide variety of vendors. Please enjoy shopping with them throughout the day!

All unit directors may visit our Directors Hospitality Room located near the cafeteria for complimentary food and drinks throughout the day. All bus drivers are also invited to our Driver Hospitality Room located in the West Campus near Unit Check In.

For your convenience, here is the Katy ISD Wifi information:

Network: KISDBeTheLegacy

Password: bethelegacy (*all lower case*)

We wish you and your performers the best of luck, and hope you enjoy your day at Katy High School!

Concessions Menu

****Cash and Credit Card accepted****

Chick-Fil-A Chicken Biscuit	\$3.00
Hot Dog	\$3.00
Hot Dog with chili and cheese	\$4.00
Cheese Nachos	\$3.00
Chili & Cheese Nachos	\$4.00
Frito Pie	\$4.00
Pizza per slice (cheese or pepperoni)	\$2.00
Chick-Fil-A Sandwich	\$6.00
Chopped BBQ Sandwich	\$5.00
Chips	\$1.00
Soft Drinks	\$2.00
Water	\$1.00
Gatorade	\$2.00
Pickle	\$1.00
Candy (chocolate, sour, etc.)	\$1.00
Homemade baked goods	\$1.00

*****MEAL DEAL- Hot dog, chips, soft drink \$5.00*****

Exit Only

Performer Drop-Off
Bus/Truck Loading &
Unloading

Spectator Parking

Floor Refold

Performance Gym

Prop
Entrance

Spectator
Parking

Spectator
Entrance

Adams St

Equipment
Warm Up

Unit
Check In

Body
Warm Up

TCGC
Parking

Overflow
Parking

N Stadium Ln

Bus Parking

Volunteer Parking

Bus
Parking

S Stadium Ln

Truck
Parking

TCGC Outdoor
Flow Katy HS

Tiger Way

Fred St

Katy Fwy

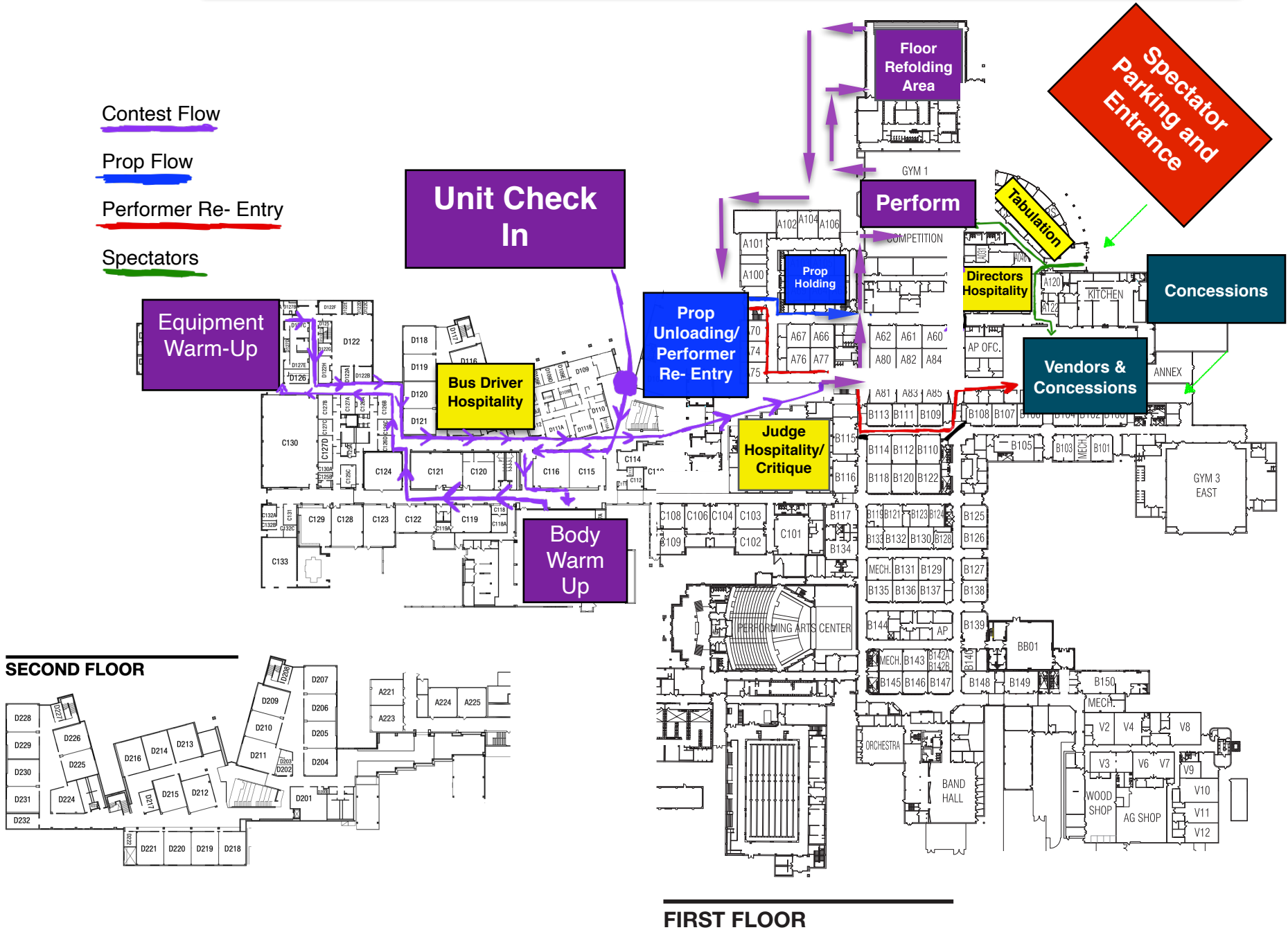

Color Guard Flow Map for
TCGC Katy Show



All TCGC contest sites must have a minimum of seventy by one hundred feet (70' x 100') to accommodate a "safety zone" of five (5) feet from any spectator seating. If no spectators are seated on the left and right sides, then the safety zone will be eliminated on the left and right sides of the competition area and can extend to a maximum of 106' x 78'.

The "competition area" at this event measures 123' X 63.' All performing groups must be prepared to perform within that area. Floors (tarps) may not extend into safety zones per rules found in the WGI Adjudication Manual and Rulebook.

Back Seating

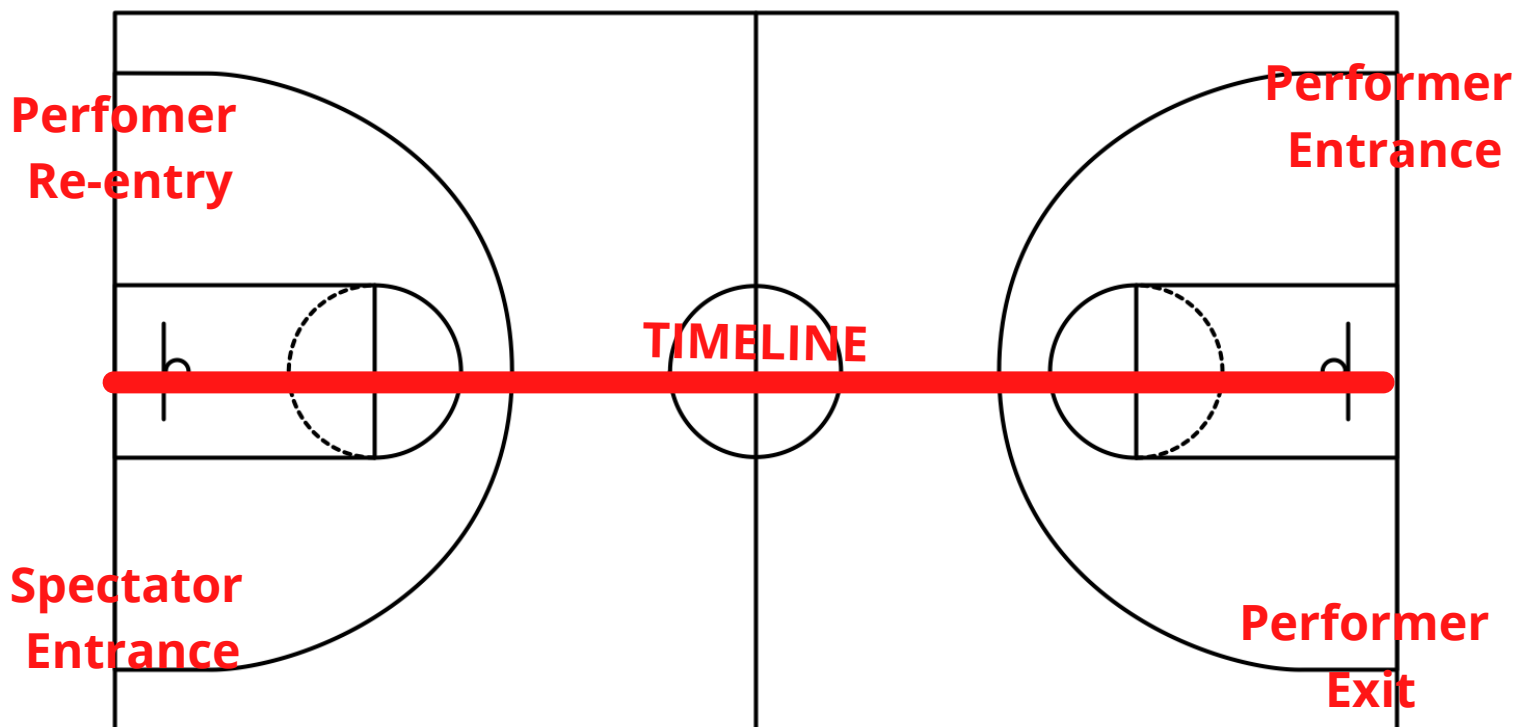

Front Seating