

2019 TCGC Bowie HS Information
Saturday, February 2
Show Start Time: 9:00AM

Facility Bowie HS
 4103 W.Slaughter Lane
 Austin, TX 78749

Ticket Prices: \$10
Cash or credit, booster organizations can make checks payable to

Please contact the show sponsor PRIOR to the show if you have any questions or have a special circumstance.

Contest Director

Jessica Mendez
westcd@texascolorguardcircuit.org

Show Host Contact

Candice Mendoza
512-579-7634
cooltxgal@gmail.com

Judging Panels

Color Guard

EQ Alice Hays
MV Jaycee Clark-Bentley
DA Tate Fincher (LJ)
GE Sandy Bertelle
GE Steve Abrams
TP Chelsea Crochet
Over David Duffy

Clinicians

Courtney Allyson
Andria Foerch
Stephanie Boisjolie
Joseph Powell

TO LISTEN TO JUDGES

COMMENTARY:

Each director should be set up with an account through CompetitionSuite. This is the ONLY WAY to receive judge's commentary for any TCGC event.

SOUND TESTING:

One hour prior to the start of the contest and during breaks at the discretion of the contest director. Music should be uploaded to CompetitionSuite.

WARM-UP AREA:

All maps are in this packet. Color guards should report one hour prior to performance time. The Show Host will provide sound equipment with auxiliary cords for MP3 or iPod use in both Warm-Up areas no CD capability will be available.

RECAPS: Recaps will be available through CompetitionSuite only

CRITIQUE: Is only offered to World Class units if applicable.

VIDEO TAPING:

No video cameras allowed and no authorized video space will be provided. TCGC does not condone nor accept liability for any unauthorized recording during an event.

Don't forget to review the [Keys to a Successful Contest Day!](#)



Directions to:
James Bowie High School
4103 W Slaughter Lane
Austin, Texas 78749

From the South:

Take IH-35 North to the Slaughter Lane Exit (#227). Take a left on Slaughter Lane heading west. Turn left into the school at the 2nd traffic light after passing Brodie Lane

From the North (I-35):

Take IH-35 South to the Slaughter Lane Exit (#227). Take a right on Slaughter Lane heading west. Turn left into the school at the 2nd traffic light after passing Brodie Lane

From the North (Mopac/Loop 1):

Take Mopac/Loop 1 South until you come to the traffic light at Slaughter Lane. Take a left on Slaughter Lane heading east. Turn right into the school at the 2nd traffic light.

From the East (Hwy 71):

Take Hwy 71 West towards Austin from the east until you get to IH-35. Take IH-35 South to the Slaughter Lane Exit (#227). Take a right on Slaughter Lane heading west. Turn left into the school at the 2nd traffic light after passing Brodie Lane

From the East (Hwy 290):

Take Hwy 290 West towards Austin from the east until you get to IH-35. Take the exit for IH-35 South via the overpass/flyover. Take IH-35 South to the Slaughter Lane Exit (#227). Take a right on Slaughter Lane heading west. Turn left into the school at the 2nd traffic light after passing Brodie Lane

Greater Austin Area Major Road Map

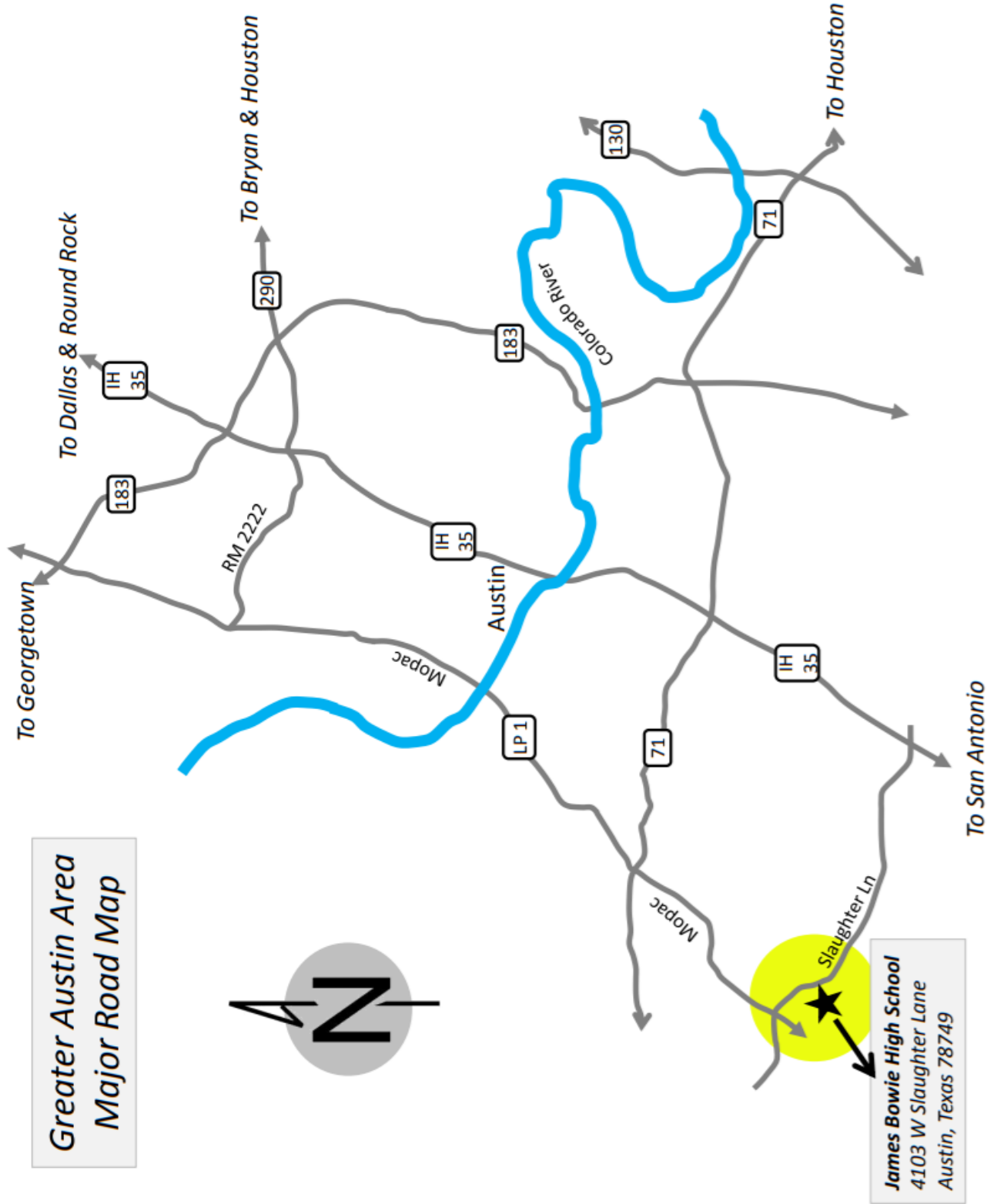
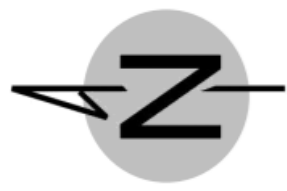

James Bowie High School
4103 W Slaughter Lane
Austin, Texas 78749

Bowie Indoor Festival MAPS and LAYOUTS

Bus Route and Check In

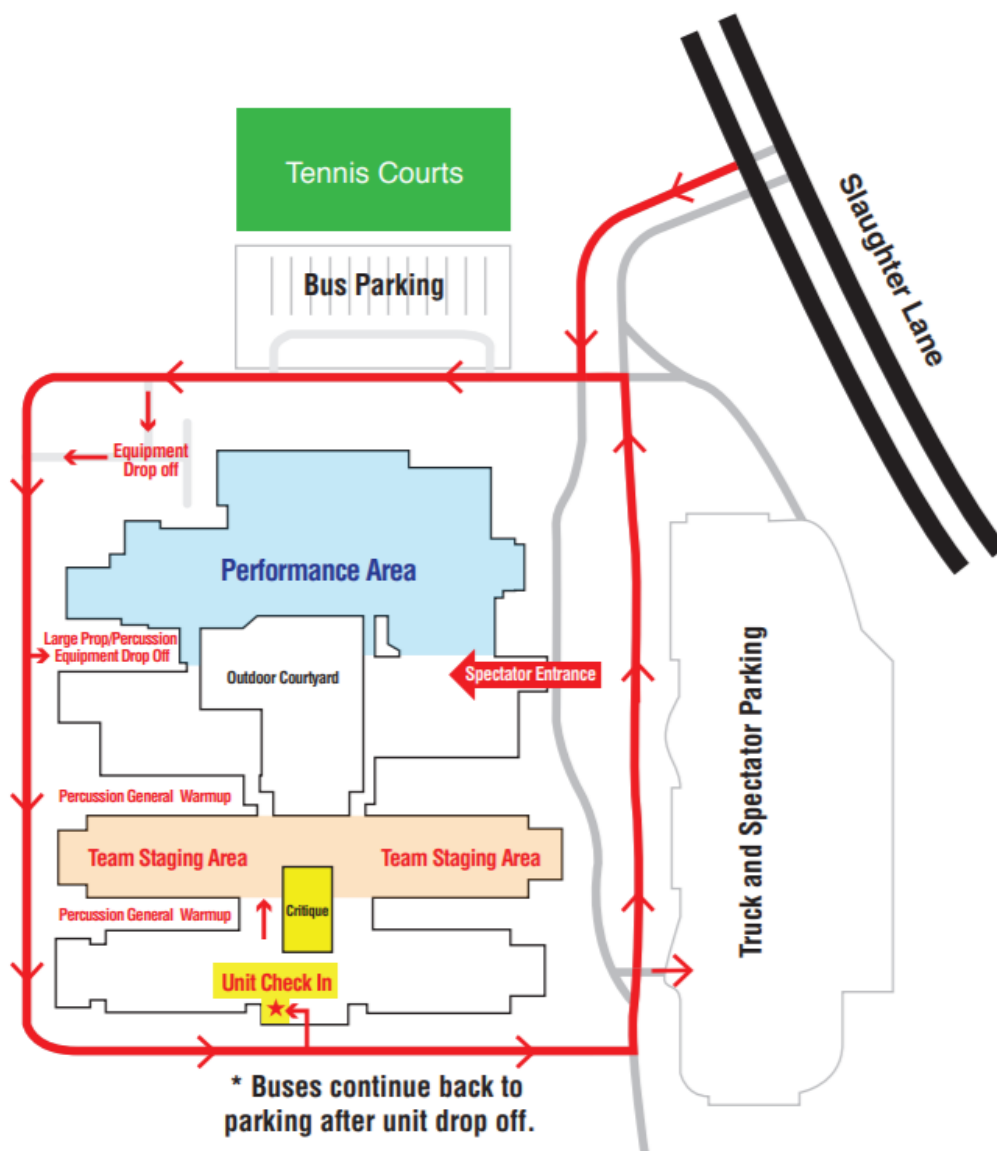

Bowie Indoor Festival MAPS and LAYOUTS: Color Guard Flow

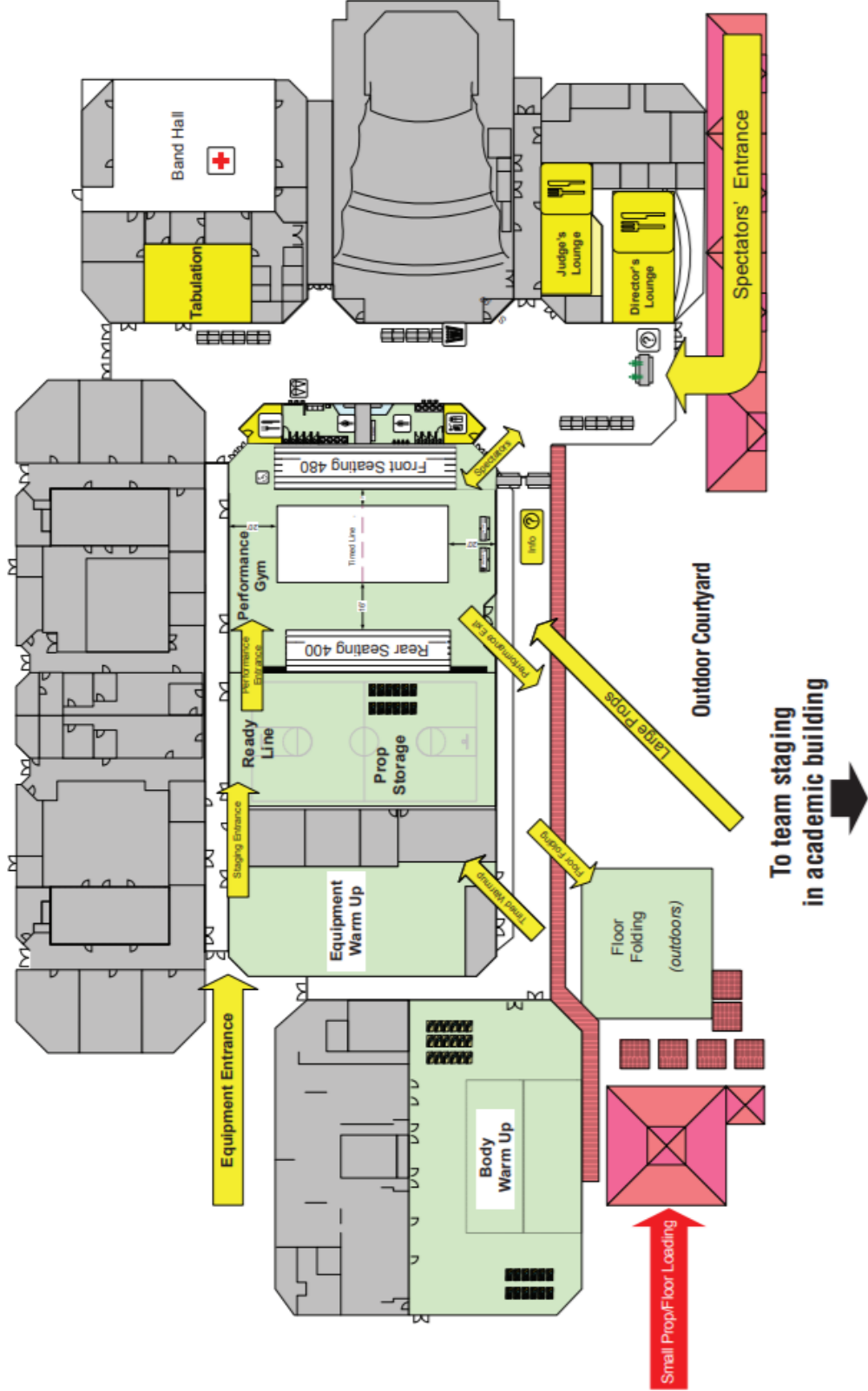



James Bowie HS

Competition Area

All TCGC contest sites must have a minimum of seventy by one hundred feet (70' x 100') to accommodate a "safety zone" of five (5) feet from any spectator seating. If no spectators are seated on the left and right sides, then the safety zone will be eliminated on the left and right sides of the competition area and can extend to a maximum of 130' x 83'.

The "competition area" at this event measures 110' x 70'. All performing groups must be prepared to perform within that area. Floors (tarps) may not extend into safety zones per rules found in the WGI Adjudication Manual and Rulebook.

