

# MCGC

Michigan Color Guard Circuit • est. 1975

# 2023

## CHAMPIONSHIPS



On behalf of the Board of Directors of the Michigan Color Guard Circuit and the Championship Committee, it is my pleasure to welcome each of you to the 2023 MCGC Championships at Saginaw Valley State University. We are pleased to be back at SVSU, as it has been our home for Championships for the past 28 years.

An event of this magnitude is only made possible by the support of many people. I would like to thank all of this weekend's volunteers, who have so graciously given of themselves in order for us to be able to provide an incredible experience for our membership.

In order to alleviate any last minute confusion, please review the enclosed information. We hope that you will find answers to most, if not all of your last minute questions during our final weekend. Thank you for a wonderful season and the best of luck for a great performance!

Brian Liwak, President  
MCGC Board of Directors

## What's inside →

FAQ.....	2
SVSU waiver.....	3
Campus map .....	4
Facility routing .....	5
Performance arena routing .....	6
Group photo form .....	7
Facility photos.....	8

# Championships FAQ

---

## SVSU WAIVER

As part of our contract with SVSU and the Ryder Center, we require all unit directors to sign a waiver agreeing to the terms of use for today's facility. Please make yourself familiar with the guidelines for today's event and help us enforce these guidelines within your group. In order to perform at Championships, all units must sign and return a copy for circuit records upon unit check-in.

## HOMEROOMS

No Homerooms are available at championships. At equipment entrance each unit is assigned a marked folding chair to identify unit property within the Turf Room.

## PROPS

Oversized garage doors are used for prop loading/unloading. Props and equipment should be removed from the building upon conclusion of your performance.

## PERFORMERS CHECKING IN EARLY

Individual performers may check in early and will receive a wristband **WHICH IS REQUIRED FOR ADMISSION** until the conclusion of Championships. *(Example: a unit checking in early to help a Regional A guard even though they themselves do not perform until later)*

## TICKETS - ONLINE ONLY

Spectator Tickets will only be available online at [mcgc.net](http://mcgc.net). Tickets will be available beginning March 15th. Cost is \$20/5 and under free. We will not be selling tickets at the door. Tickets can be purchased beginning March 15th and throughout the day of championships online only. Spectators will receive an email with a QR code that will be scanned at the door. It can be printed or displayed on a phone for entry. Help your family and friends!!

## VOLUNTEER ASSIGNMENTS

Volunteer assignments/communication is in progress.

## WARM-UP

Each Guard will have two times their interval time in a body warm-up. These areas changed in 2018 so please use your maps. Body A to Equipment A, Body B to Equipment B. After your warm-up you will have designated travel time to move to Equipment warm-up in the Hamilton Gym and then on to the performance area. Equipment is allowed in the Body warm-up but no manipulation is permitted. No stretching of any kind will be allowed in the Turf Room. Please be conscious of sound restrictions in body warm-up areas adjacent to performance space. Group Photos will be taken prior to warm-up.

## CHAMPIONSHIPS VIDEO POLICY

**NO VIDEO OR AUDIO RECORDING AT CHAMPIONSHIPS.** If anyone is found in violation of this policy, the video/audio recording equipment may be confiscated and returned at the conclusion of the contest. This includes mobile devices. Please make sure your parents and students are aware of this. A recording of your streamed performance will be supplied by FloMarching and will be emailed to the director. It cannot be uploaded to any public social media or website.

## PHOTOGRAPHY - BEFORE WARM-UP

Bateman Photography will be providing the MCGC with group photos for championships. Please be sure to have your group photo taken according to your time slot on the schedule. Have your unit organized and ready to listen to the photographers instructions. Fill out the order form (page 7) ahead of time and submit your payment when the photo is taken. Bateman Photography will also be providing action shots. The photos will be provided on [mcgc.net](http://mcgc.net) when the photos become available. As with any MCGC event, **PHOTOGRAPHY WITH A FLASH IS PROHIBITED**. Please feel free to take plenty of pictures—just leave the flash turned off. Please make sure your parents and students are aware of this.

## CONCESSIONS

Concessions are available on the main concourse. Additionally, Papa Johns and Marketplace at Doan (food court) are available (see map) on SVSU's Campus, just a short walk from the arena. There may be a food truck or two in the parking lot at the bottom of the ramp at the spectator entrance.

## PICNIC AREA

A Picnic Area is available on the upper level of the field house for units to bring in their own food/beverages to save on costs and Concourse traffic. All food/drinks must be restricted to this very visibly marked area. Please respect that other units may need to use the space as well, so do not loiter!

## PROGRAMS

Programs are available at the spectator entrance.

## SHOUT OUTS

"Shout outs" are not available to purchase at MCGC Championships.

# 2023 UNIT REFERENCE COPY

## MCGC CHAMPIONSHIPS CONTEST GUIDELINES

Saginaw Valley State University • Ryder Center



Please make sure your members, staff and volunteers are aware of the following policies. Any person or unit found in violation of these guidelines for the following areas may result in a penalty and/or disqualification from the MCGC Championships Contest. We ask that all directors and staff members help to monitor the facility throughout day. We have over 200 volunteers working in and around the facility throughout the event, but every set of eyes and hands help.

1. At Unit Check-In, only the number of students registered on your Unit Roster (verified by the circuit deadline) will be allowed to enter the arena free of charge. All additional students and/or personnel will be required to purchase a full price ticket.
2. Anyone caught misusing or giving their MCGC credentials to another person to gain entry to the show or authorized areas will be asked to leave and their pass confiscated. This could also cause your unit to be penalized and/or disqualified. Wristbands will be distributed to all staff and directors at check-in.
3. Please remember to have your group's picture taken prior to your warm-up. This is for the MCGC Archives as well as for display at the MCGC merchandise booth in coming years.
4. Units unloading props or equipment can only do so two (2) hours prior to their performance time. There will be absolutely no exceptions. This includes all props, equipment costumes and/or uniforms. Load-in time adjustments may be made in the case of inclement weather and will be determined by the MCGC Board or Championships Committee.
5. Units may check-in WITHOUT EQUIPMENT OR PERSONAL GEAR prior to the above-stated two (2) hour window if you are assisting another unit on and off the floor or watching other units. NO PERSONAL GEAR OR EQUIPMENT IN THE TURF ROOM UNTIL TWO (2) HOURS PRIOR TO PERFORMANCE TIME.
6. If your unit has large props to build, please try to unload them out of the way of the traffic flow. Turf room workers will assist you with the proper place to do this. Please have your prop staff exit the turf room as soon as they are finished.
7. All props and equipment must be loaded as soon as possible after your unit's performance. There will be absolutely no exceptions. Please do not ask the workers in the turf room for "favors".
8. Please remove all personal items (ie. coats, clothing, equipment, purses, etc.) as soon as possible after your performance and pictures are done. You may put them in your cars, buses or take them with you into the stands.
9. Performers are to view the show from the side stands only unless they purchase a ticket and have the proper wristband to get into the front stands. The front stands are for paying spectators only. We are growing every year as is the size of our Championships crowd. Seating will be tight with many units in attendance. Please make sure your members understand this rule.
10. Once your performance is done, please help keep your members out of the turf room area. There is limited space for performing groups to use throughout the day. Please be considerate of groups that are waiting to perform.
11. PICNIC AREA: Groups are asked to be responsible for the Picnic Area while they are using it. All trash must be placed in the cans provided. Please make room for others as multiple groups may utilize this area at the same time. Units are asked to leave the area as clean as or better than they found it. NO LOITERING IN THE PICNIC AREA.
12. Food and/or drink are only allowed in the Picnic Area. Food and drink cannot be in any other part of the turf room. This will help to protect units' equipment and their safety. All additional food items must be kept in the upper concourse area of the arena.
13. Please use the dressing rooms/locker rooms (or other designated areas) for dressing and makeup. This is to help keep the turf room area clean and avoid accidents/misuse of makeup materials. NO GLITTER OR HAIRSPRAY IN THE TURF ROOM! If your unit uses excessive or dark makeup for performance, we ask that you clean up after yourselves in all dressing rooms, locker rooms and restrooms. Leave these areas clean for the next unit to use.
14. There is to be NO PAINTING, GLUING OR TOUCH-UPS OF PROPS in the turf room.
15. There is to be NO SPINNING OF EQUIPMENT or PLAYING OF MUSICAL INSTRUMENTS in the turf room area. This includes Color Guard equipment or musical instruments of any kind. The curtain is the only barrier between the turf room and the performance arena. Please be considerate of all performers during their championships performances.
16. You may do stretching only in the designated body warmup area. You MAY NOT DO ACROSS-THE-FLOORS OR MARCHING BASICS in the turf room. Space is at a minimum for all units.
17. YOU ARE NOT ALLOWED TO CLAP HANDS OR PLAY ANY MUSIC in the turf room. The sound will carry over into the performance arena.
18. The Auxilliary Gym is designated for scheduled body warmup only. Be aware that sound will carry to the performance arena. Keep sound(s) to a minimum.
19. The judges' room(s), MCGC Board area and hallway are OFF LIMITS TO EVERYONE. This includes all staff members from competing units. Please do not try to talk to the judges during their free time while in the Judges' Room(s). They are working a long day and need a place to relax away from the "action". Please be respectful of their needs.
20. The MCGC and Ryder Center are not responsible for monitoring personal items left in the turf room. If possible, leave all valuables locked in your vehicles during the event or have a support person monitor your belongings.

Thank you for your help in making the MCGC Championships a well-run and great experience for all participants. Your help enforcing these guidelines is sincerely appreciated.

I have read the preceding guidelines and fully understand my obligations as a representative of my MCGC unit to help maintain order with my members, staff and support personnel. I fully understand that my unit may incur some form of penalty if we are found in violation of these guidelines. **THIS FORM MUST BE SIGNED IN ORDER FOR YOUR GROUP TO PERFORM TODAY AT THE MCGC CHAMPIONSHIPS CONTEST.**

UNIT NAME: \_\_\_\_\_

UNIT DIRECTOR: \_\_\_\_\_

DATE: \_\_\_\_\_



7400 Bay Road • University Center, MI 48710 • [www.svsu.edu](http://www.svsu.edu)

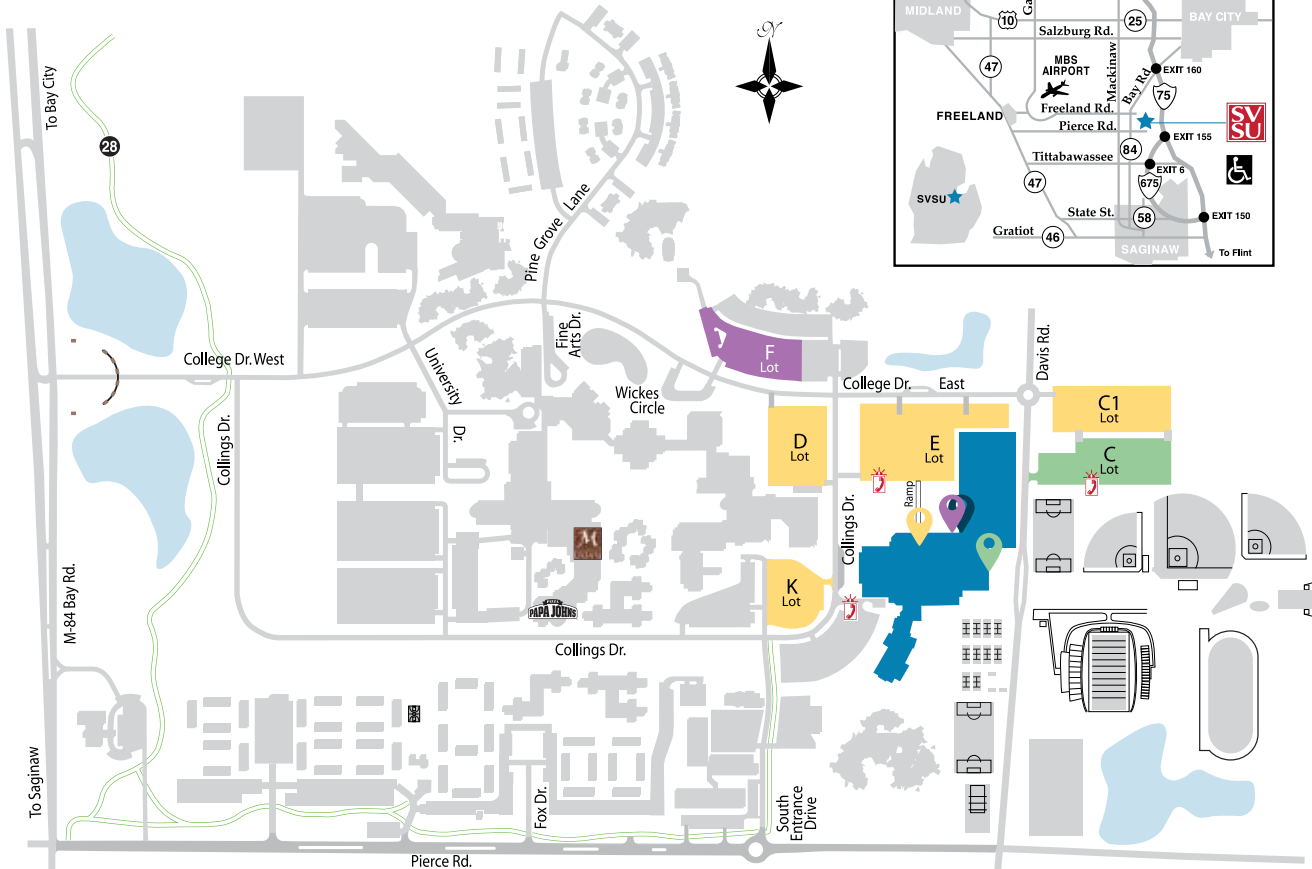

 Ryder Center Arena

 Volunteer entrance  
Lower level

 Spectator parking

 Spectator entrance  
Upper level, top of ramp

 Marketplace at Doan  
Open Saturday from 11-8pm

 Bus/Trailer parking

 Unit entrance  
Lower level

 Papa John's  
Open Saturday 6pm-midnight

 Semi/Trailer parking

 Prop unloading/loading  
Ground level



Smoking is permissible only in lettered and residential parking lots, at least 25 ft. from any building.



# Saginaw Valley State University Ryder Center Arena

## Unit Routing map

(upper and lower levels)

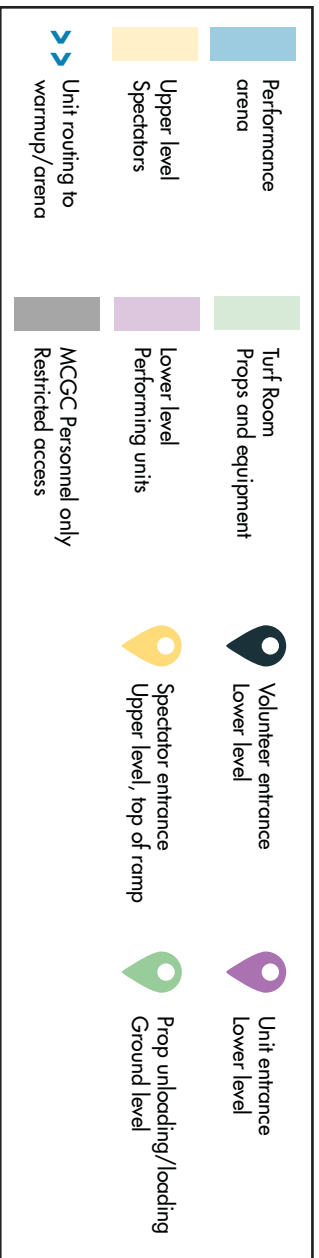
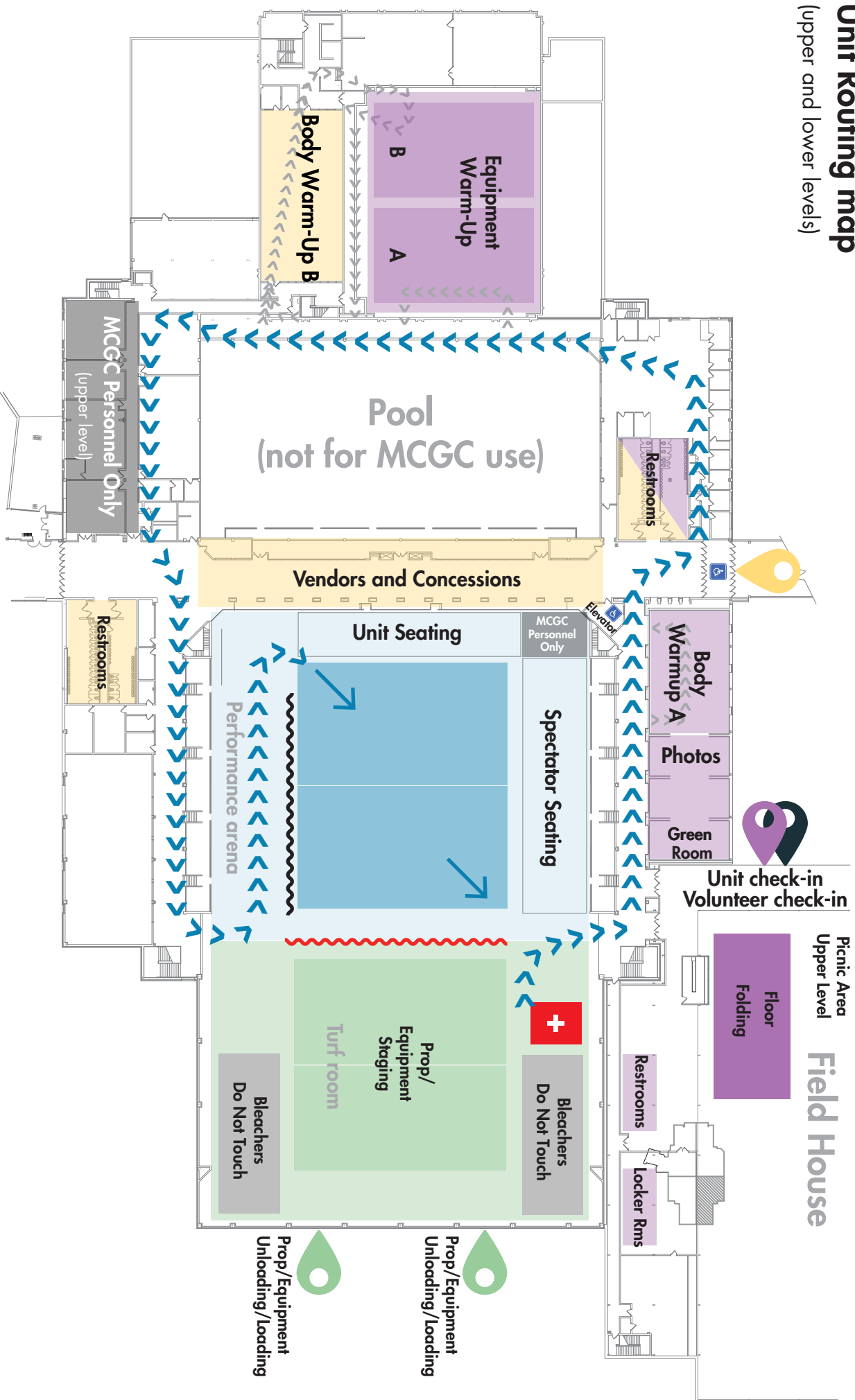

# Performance arena routing

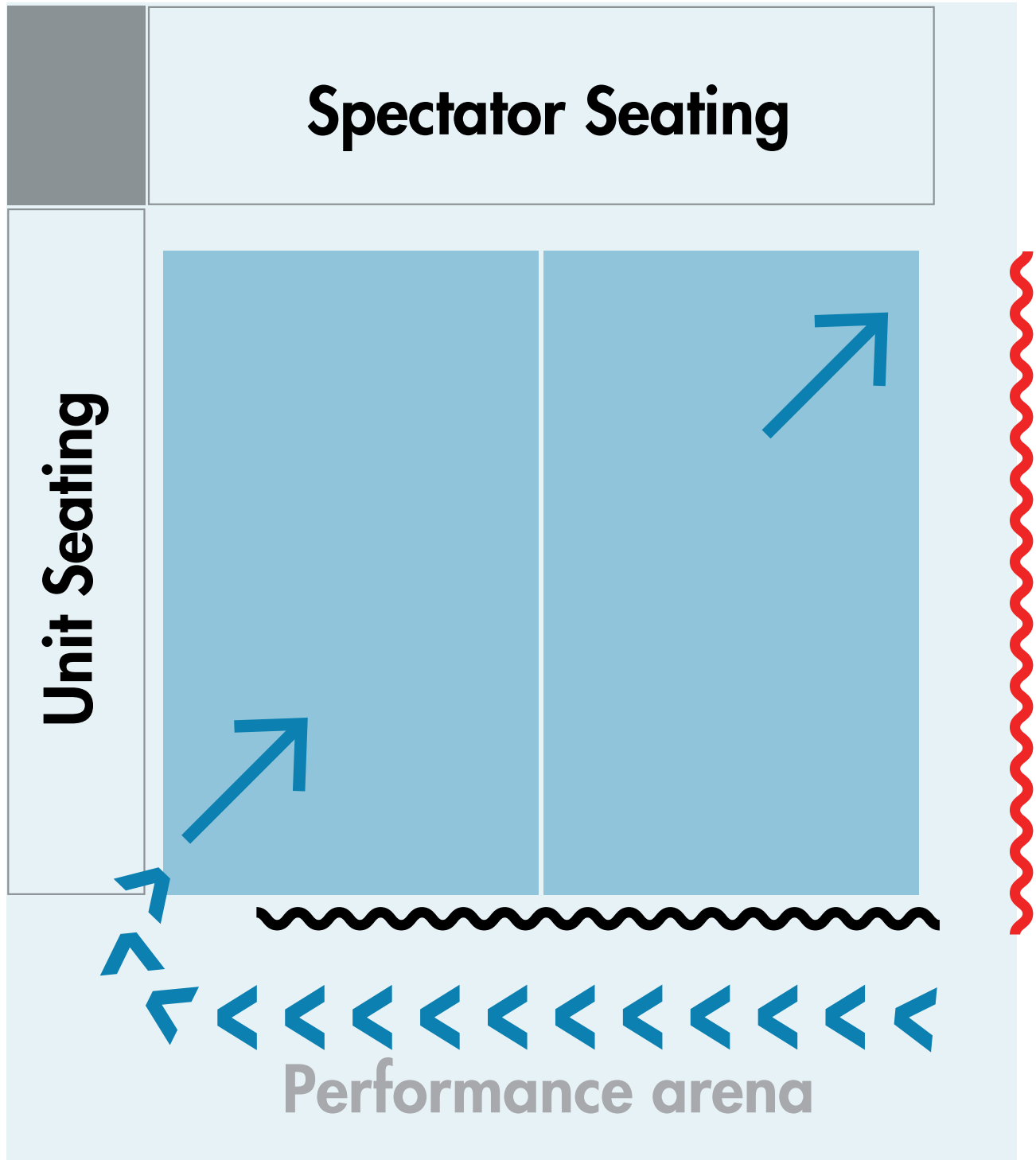





# MCGC

## GROUP ORDER FORM SIGN-UP SHEET

P: 317-913-9027  
E: BATEMANPHOTO@MSN.COM  
W: WWW.BATEMANFOTO.COM  
7026 CRICKLEWOOD RD  
INDIANAPOLIS, IN 46220

Please present this form and money to the photographer at the time the photo is taken.

**More Orders = More Savings! Thanks!**

Photocopy and use additional sheets as needed. All photos will be sent to ONE person for distribution.

NAME OF GROUP: \_\_\_\_\_

Mail photos to: \_\_\_\_\_

Address: \_\_\_\_\_

City, State, Zip: \_\_\_\_\_

**Please indicate Formal Pose,  
Fun Pose or Senior group!**  
(All count for your total.)

Photographic prints are 11" x 14"

1 - 5 Orders- cost is \$30.00 per photo (save \$16.00)

6 - 19 Orders - cost is \$25.00 per photo (save \$21.00) & Director receives one free photo.

20-49 Orders - cost is \$20.00 per photo & Director receives 3 Free Photos

50-99 Orders - cost is \$15.00 per photo & Director receives 5 photos & a 16" x 20 " Wall Print

1 \_\_\_\_\_

2 \_\_\_\_\_

3 \_\_\_\_\_

4 \_\_\_\_\_

5 \_\_\_\_\_

6 \_\_\_\_\_

7 \_\_\_\_\_

8 \_\_\_\_\_

9 \_\_\_\_\_

10 \_\_\_\_\_

11 \_\_\_\_\_

12 \_\_\_\_\_

13 \_\_\_\_\_

14 \_\_\_\_\_

15 \_\_\_\_\_

16 \_\_\_\_\_

17 \_\_\_\_\_

18 \_\_\_\_\_

19 \_\_\_\_\_

20 \_\_\_\_\_

21 \_\_\_\_\_

22 \_\_\_\_\_

23 \_\_\_\_\_

24 \_\_\_\_\_

25 \_\_\_\_\_

26 \_\_\_\_\_

\_\_\_\_ YES, PLEASE! I WANT A DIRECTOR'S PHOTO!

Director's photo (one per group) is available for a \$6.00 Shipping fee. This is waived if there are 6 or more orders. Please return this form to the group area photographer at championships.

## Prop loading/unloading (garage door)





## Main Concourse | Concessions and Vendors



## Green Room



## Warm-up Body A



## Warm-up Body B





## Warm-up B & A (Cardinal Gym)

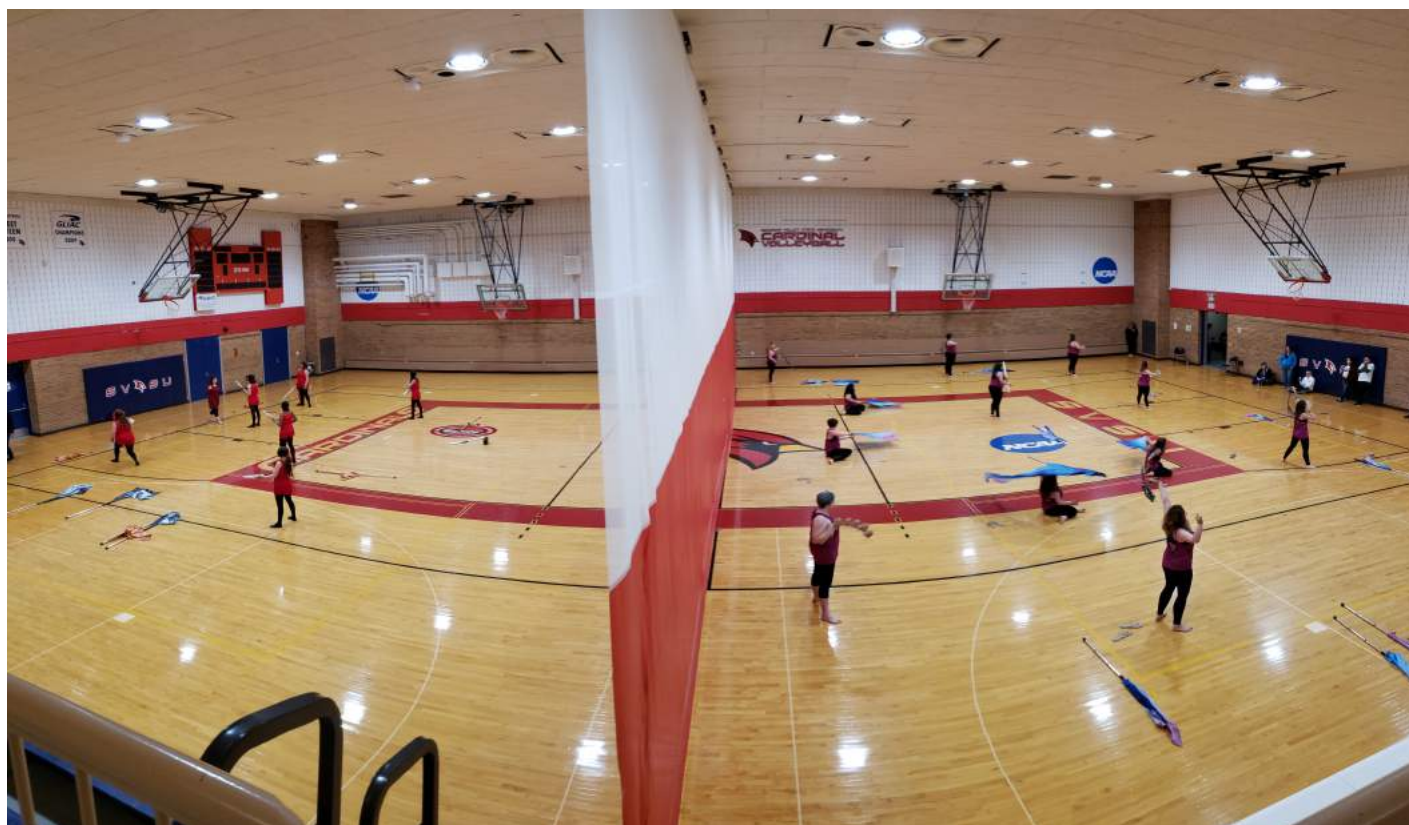

## Warm-up B (Cardinal Gym)



## Turf Room | Back Stage



## Arena | Back Stage Unit Entry





**Arena | From Back Corner (side 2)**



**Arena | From Front Stands**



## Spectator Entrance



## Picnic Area

