

2019 Campo Verde Winter Invitational

PERCUSSION FOCUS SHOW



Director, Instructor, or Unit Manager:

We would like to welcome you to the 2019 Campo Verde Winter Invitational on Saturday, March 2nd, 2019. Please review the following information to ensure a smooth show throughout the day. For any show flow questions refer to the attached maps. Thank you for choosing to attend the Campo Verde Show and we hope you have a great show experience!

Address:

Campo Verde HS
3870 S. Quartz St.
Gilbert, AZ 85297

Admissions:

All units will be given 7 wristbands for your parent helpers and staff. You also may have passes given to you by WGAZ that will work for admission. ALL ADDITIONAL HELPERS MUST PURCHASE A WRISTBAND! Even just to help push equipment into the show.

\$8 Admission

Free admission for children 5 and under

Spectator Parking:

Spectator parking is located on the west side of campus. This is different than previous year. Spectators must enter on the west side of campus. In the case that the west lot gets too full, additional spectator parking can be found on the east side of campus, at Quartz Hill Elementary or in the surrounding neighborhood.

Bus and Truck Parking:

All buses and equipment trucks must enter in the EAST side of campus off of Germann Road. Buses and trucks will turn onto Quartz St and head to our NORTH parking lot. Trucks will be allowed to enter the north lot, however, buses will drop students off and then continue to loop around CVHS to the west and exit onto Germann. Buses will proceed west on Germann and park at Central Christian Church. Please communicate with your drivers about coming back to pick up your unit after awards.

Practice Floors and Time Line:

Per WGAZ policy, units are not permitted to open performance floors in the parking lot. Also due to space limitations, practice floors may only be opened on the outdoor basketball courts or tennis courts on a first come, first served basis. The time line for this show is vertical. See attached gym map.

Water Stations:

There will be several water stations around campus for your students. Please stay hydrated!

Check In & Video

There will be a station near the north parking lot for unit check-in. A unit representative must check in and pick up a unit packet that will contain wristbands for both staff and performers. There is no videotaping or flash photography allowed. Your unit should have ONE video pass that you can use throughout the season.

Concessions:

Please let your students and parents know that there will be a full concession stand and vendors available for their lunch and/or dinner needs. No food or drink is allowed in the gym.

Director Hospitality:

The Director and Staff Hospitality room will be in the band room in building 3. We will have snacks and drinks available.

Have a great show!

Please contact us for any questions or emergencies regarding the show.

Matt Kozacek
Director of Bands
480-234-9158
matt.kozacek@gilbertschools.net

Taylor Mitchell
Assistant Director of Bands
taylor.mitchell@gilbertschools.net

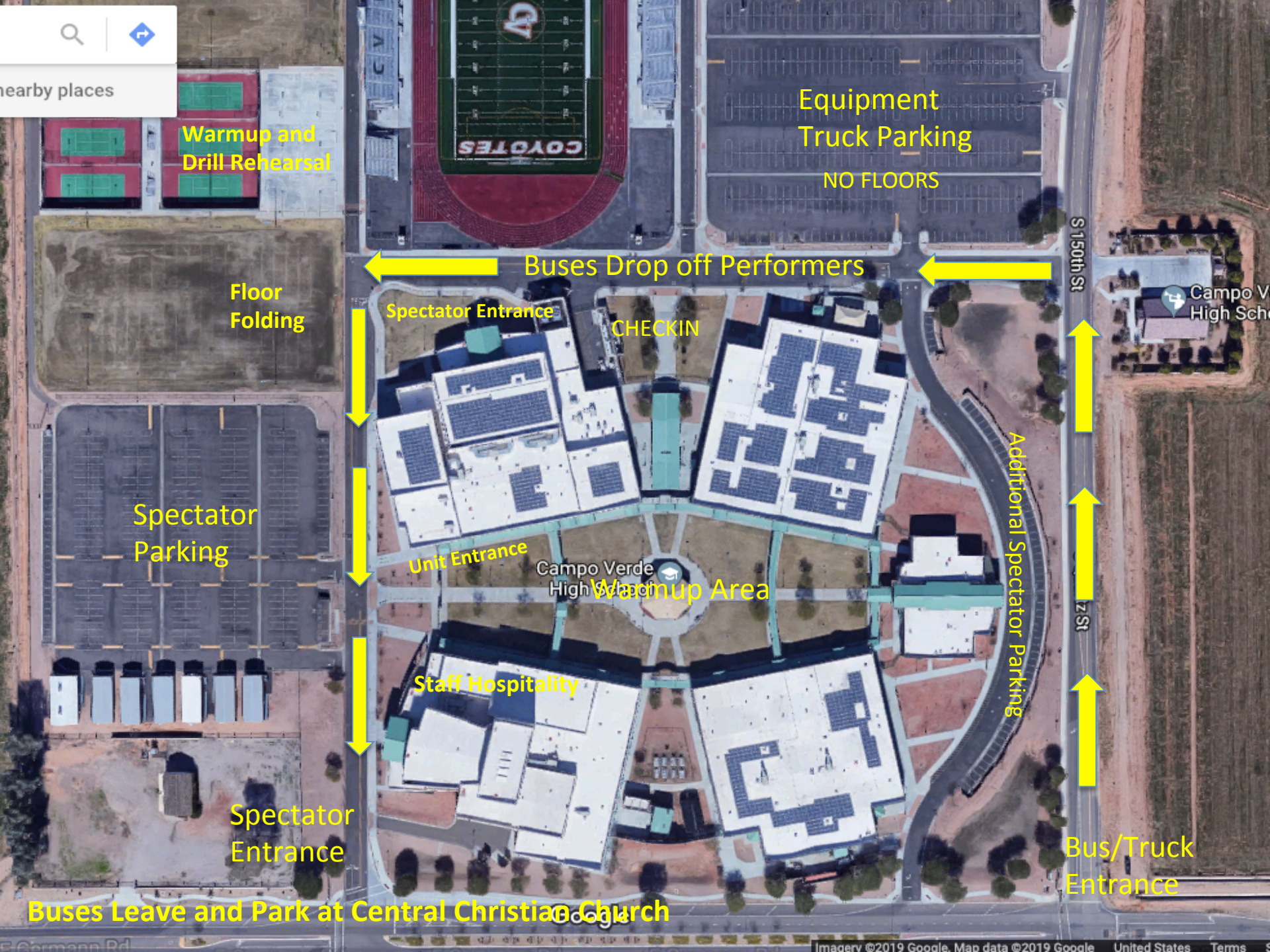

nearby places

Warmup and
Drill Rehearsal

Equipment
Truck Parking
NO FLOORS

Floor
Folding

Buses Drop off Performers

Spectator Entrance

CHECKIN

Spectator
Parking

Unit Entrance

Campo Verde
High School

Warmup Area

Staff Hospitality

Additional Spectator Parking

S 150th St

Campo V
High Sch

12th St

Spectator
Entrance

Bus/Truck
Entrance

Buses Leave and Park at Central Christian Church

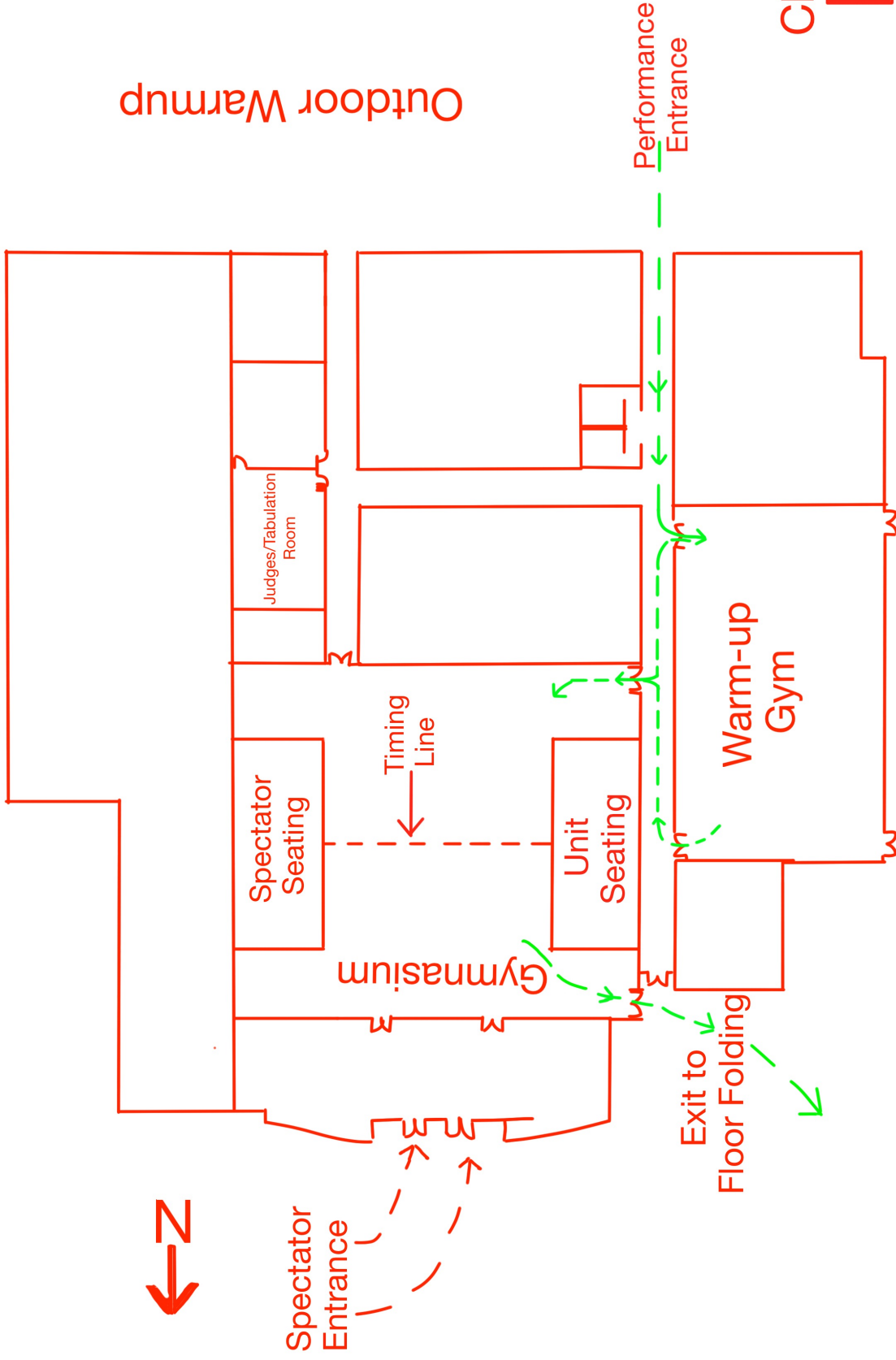

Outdoor Warmup

Check In

