



## **Percussion/Winds Championships Contest Information Friday & Saturday, April 14 & 15, 2023**

### **LOCATION**

Millennium High School  
14802 W Wigwam Blvd  
Goodyear, AZ 85395

### **EMERGENCY CONTACT (DAY OF SHOW ONLY)**

Contest Administrator: Robin Montoya 915.494.8232  
Event Partner: Brent Godbehere (Band Director) 602.696.0482

### **FAN PARKING**

Fan parking is located West on Wigwam, school is on the right. Please pull in the second parking lot where all the fences are.

### **BUS/TRAILER PARKING**

All trucks may drop off equipment near our tennis courts then proceed forward to truck parking/overflow. Units may also choose to unload in the overflow parking lot.

Busses and equipment vehicles will enter MHS from the entrance located on the southwest side of the campus. Please do not attempt to bring busses through the fan (spectator) entrance.

Semi-trailers will park in the student pick up/drop off zone at the front of the school off of Wigwam Blvd.

### **CHECK IN & VIDEO**

There will be a station across from the auditorium south of the stadium.

A unit representative must check in and pick up a unit packet that will contain wristbands for both staff and performers.

Directors will be given 7 wristbands for admission to the event. These wristbands will not guarantee front side seating. Additional staff/parent helper passes can be purchased at the through GoFans.

There is **NO** video recording or flash photography allowed.



## PASSES

Units will be given 7 staff wristbands in addition to the performer wristbands for entrance passes. These will be distributed at Unit Check-in. Your unit badges **WILL** be recognized this year. **PLEASE REMEMBER YOUR BUS/TRUCK DRIVERS!**

- Directors can pick up packets Friday for both Friday and Saturday performers. Please let Denise know if you have multiple units (guard only) and would like to pick up all packets ([help@wgaz.org](mailto:help@wgaz.org))
- Wristbands are good for both days and if removed it will be up to the unit to purchase a replacement, **NO EXCEPTIONS**
- To prevent a delay in show, WGAZ asks that all performers, staff and parent/volunteers to be wearing their wristbands at all times during WGAZ Championships.
- WGAZ is requesting anyone wearing a **performer wristband** to sit in their designated areas while inside.

## WARM UP

Warm up will be located throughout the campus (please see map).

Units may **NOT** open performance floors on the outdoor courts or parking lots. Please refer to the maps provided for specific warm-up locations.

## PROP/FLOOR STORAGE

There is a designated prop/floor storage available outside east of the arena. There will be space available on the turf grass, sidewalk and sidewalk/street leading to the arena. (between the stadium and arena)



# ORDER NOW

[bravwellvideo.com](http://bravwellvideo.com)

## HD Downloads *starting at* \$20

Videos are delivered 4-6 weeks after the event.



# WGAZ

PERFORMING ARTS  
CHAMPIONSHIPS





### **STAFF VIEWING LOCATIONS**

There will be a staff viewing area located at the top of the bleachers for 7 staff members. (see photo)

There will be a staff/crew (pit crew, parent helpers, etc.) viewing area located on the first two rows of bleachers located on the left side as you walk through performer entrance. This area has 7 seats for staff/crew. (see photo)

There will be a sound engineer area located at the top of the bleachers near the judge's area. (see photo)

There is to be no sitting on the stairs or aisles.

The staff viewing area is reserved for staff of the currently performing unit's performance. After your unit has performed, please find an alternate seating location to enjoy other performances.

### **PERFORMANCE ENTRANCE**

The performance entrance is on the north side of the performance gym.

### **PERFORMANCE EXIT**

Units will exit through the doors located on the north side of the performance gym directly to floor folding.

### **DIRECTORS HOSPITALITY**

There will be a hospitality area located in the band room.

### **BUS/TRUCK DRIVER HOSPITALITY**

There will be a bus/truck driver hospitality area located east of the auxiliary gym. (Tigers Den)

### **CONCESSIONS**

There will be full concessions located outside by the performance gym.

Cash and cards will be accepted | *No food is allowed in the Gym.*

### **RESTROOMS**

Performer restrooms are located near the auditorium south of the band room.

### **WATER**

WGAZ highly encourages you to provide water for your performers.



## **AWARD CEREMONIES**

**FRIDAY:** There will ONE (1) full retreat award ceremony.  
The award ceremony will take place at 9:15PM.  
Location and staging will be located outside by floor folding.  
Top 3 units in each PSA-L round will move to Saturday.

**SATURDAY:** There will be TWO (2) full retreat award ceremonies.  
The first award ceremony will take place at 3:25PM.  
Top 6 units in PSA will move to finals.  
The second award ceremony will take place at 10:00PM.  
Location and staging will be located outside by floor folding.

*WGAZ encourages performers to wear any medals previously earned at WGAZ or WGI events for Finals retreat.*

## **TICKET SALES**

1 block \$18 (good for any individual block for that day)  
Multi Block Combo Pass \$30 (good for both days)  
5 and under – Free

WGAZ is ready for the new indoor season and excited for all the events to come. To ensure students, staff, and fans are safe and can easily access events, we have partnered with GoFan to provide digital tickets and contactless payments. To buy tickets, visit our GoFan page. <https://gofan.co/app/school/AZ86318%E2%80%8B>

Please note:

- Check standard schedule of the event to confirm ticket purchases.
- Ticket purchases will be online or through a QR code only.
- Show proof of tickets on GoFan App to receive a wristband.
- Masks are highly encouraged at WGAZ events.
- Limited seats will be available.

*WGAZ recommends all fans to arrive 30 minutes before units performance.*



## **COMPETITIONSUITE DETAILS**

ACCESSING YOUR GROUP - <https://help.competitionsuite.com/article/16-accessing-your-group>

ADDING YOUR STAFF - <https://help.competitionsuite.com/article/61-adding-staff-members>

ACCESSING COMMENTARY - <https://help.competitionsuite.com/article/17-accessing-commentary>

MUSIC UPLOADS - <https://help.competitionsuite.com/article/74-uploading-performance-music>

Score Summary Sheets are also located in your CompetitionSuite account with your overall score.



WGAZ

PERFORMING ARTS

Percussion / Winds Championship  
Photography



We are proud to support the local music and visual arts community for the past 10 years. Please scan the barcode or visit [www.bradkathrinsphotography.pixieset.com](http://www.bradkathrinsphotography.pixieset.com) to purchase full-resolution image downloads or to order prints and gifts.



## JUDGE PANEL

Friday, 4/14/2023					
Class	Music	Music Effect/Art	Visual	Visual Effect	T&P
PSA-L	Terry Sanders	Bret Cappelluti	Alex Mendoza	James Hudson	Karen
	Aaron Tucker	Joe Fant	Joe Roach	Mason Tanquary	
Saturday, 4/15/2023					
Class	Music	Music Effect/Art	Visual	Visual Effect (overall for winds)	T&P
PSE	Terry Sanders	Bret Cappelluti			Karen
PSCJ/PSCA	Terry Sanders	Bret Cappelluti			Karen
	Aaron Tucker	Joe Fant			
PSJH/PSRA	Aaron Tucker	Joe Fant	Alex Mendoza	Dan Hoffman	Karen
	Dan Bryan	Joe Roach	Jeff Whipple	James Hudson	
PSA	Terry Sanders	Bret Cappelluti	James Hudson	Mason Tanquary	Karen
	Aaron Tucker	Joe Fant	Alex Mendoza	Dan Hoffman	
WSA/WIO	Travis Larson	Kevin Joseph	Alex Mendoza	Joe Roach	Karen
	James Hudson	Dan Bryan	Jeff Whipple	Bret Cappelluti	
Finals					
PSA/PIA	Dan Bryan	Joe Roach	Jeff Whipple	Dan Hoffman	Karen
	Terry Sanders	Bret Cappelluti	James Hudson	Mason Tanquary	
PSO / PIO / PIW	Terry Sanders	Bret Cappelluti	James Hudson	Mason Tanquary	Karen
	Aaron Tucker	Joe Fant	Alex Mendoza	Dan Hoffman	
PLEASE NOTE, THERE WILL BE A SHORT CRITIQUE FOR GROUPS GOING TO DAYTON.					

## EVENT STAFF

Contest Admin: Robin Montoya

T&P: Karen Herrera

Sound Engineer: Aaron Hudson/Anthony Montoya

Tabulator: Monica Scheidecker

*Judge and Staff assignments and schedules subject to change*



**SITE:**

Millennium High School  
14802 W Wigwam Blvd  
Goodyear, AZ 85395

**DIMENSIONS:** 100' X 72'

**FRONT SIDE BLEACHER ROWS:** 30

**SEATING CAPACITY:** appx 3200

**APPROXIMATE CELING HEIGHT:** appx 40 ft

There are no stairs to contend with in the competition area.

There are retractable hoops above the competition floor.

Units enter the competition area directly from outside.

There is electrical power available at the front and back sidelines.

Units exit the competition area directly to the outdoors.

There is no indoor prop storage available before your performance.

There is a designated prop/floor storage available **outside** east of the arena. (between the stadium and arena)

There is a designated fold the floors area outside the exit after the performance.

There will be a black, appx 75'X100', vinyl tarp with covering the performance gym floor.

The distance from the outdoor warm up area to the competition area is less than 10 minutes.

The distance from the indoor warm up area to the competition area is less than 10 minutes.

There will be an official body and equipment warm up area.

**WARM UP AREAS**

See Map



# ARIZONA'S #1 APPAREL PROVIDER FOR THE MARCHING ARTS



## WHERE WE CUSTOMIZE YOUR STYLE

## SCREEN PRINTING AND EMBROIDERY

CUSTOM VINYL PROPS

BAND JACKETS

QUICK TURN  
AROUND TIME

SHOW SHIRTS

STAFF POLOS

FUNDRAISING  
OPPORTUNITIES

[www.MVPapparel.us](http://www.MVPapparel.us)

EMAIL

[Info@MVPapparel.us](mailto:Info@MVPapparel.us)

CALL

480-808-1MVP



# WGAZ

PERFORMING ARTS



PERFORMANCE GYM – FAN (SPECTATOR) VIEW:



PERFORMANCE GYM – PERFORMER VIEW

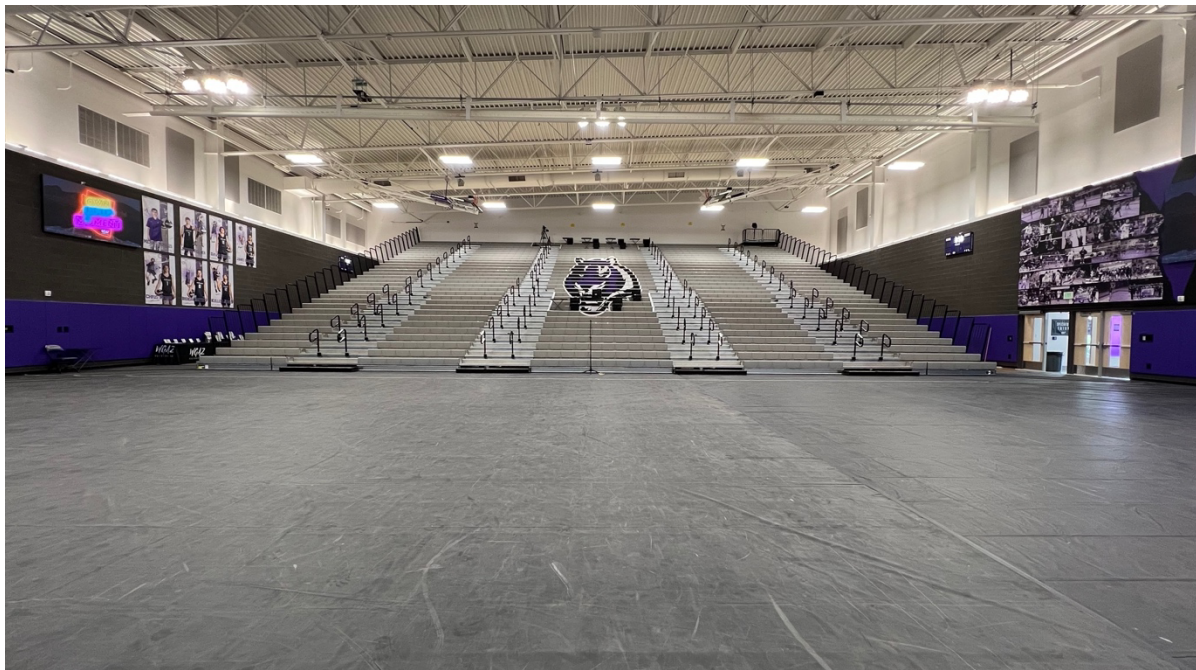





## PERFORMANCE GYM – PERFORMER SEATING



## PERFORMANCE GYM – PERFORMER SEATING OVERFLOW





PERFORMING ARTS



## PERFORMANCE GYM – PERFORMER ENTRANCE & EXIT



## PERFORMANCE GYM – PERFORMER ENTRANCE AND EXIT CONT.

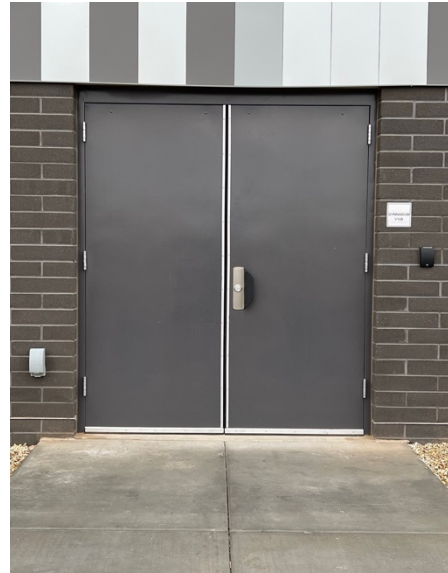



# WGAZ

PERFORMING ARTS



PERFORMANCE GYM – PERFORMER ENTRANCE AND EXIT  
DOOR WIDTH – 65" FROM DOOR TO DOOR & 61.5" AT THE NARROWEST

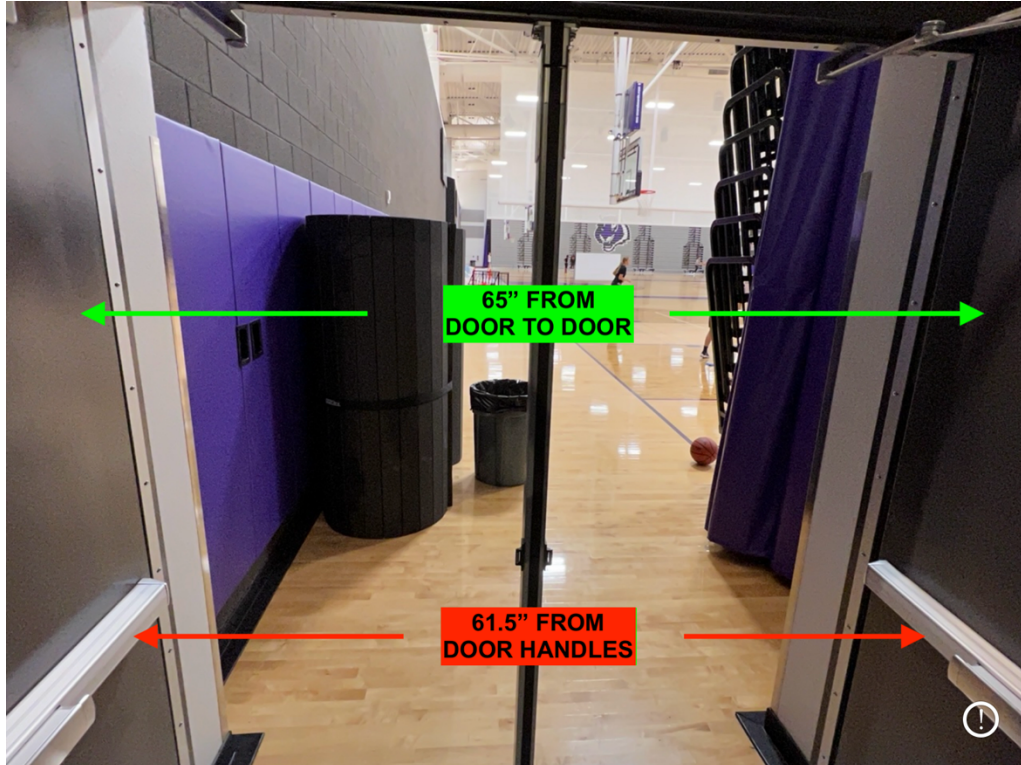

PERFORMANCE GYM – PERFORMER ENTRANCE READY LINE

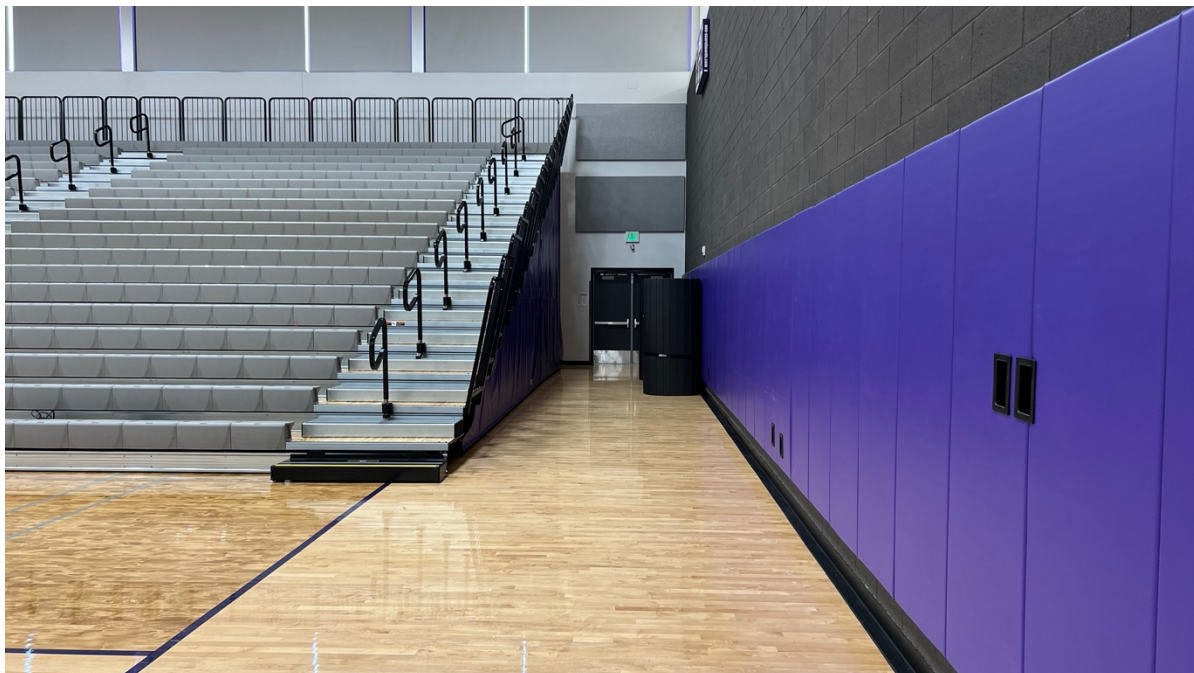





PERFORMANCE GYM – FLOOR FOLDING (PARKING LOT NORTH OF GYM)



PERFORMANCE GYM – PROP STORAGE (BETWEEN ARENA AND STADIUM)





# WGAZ

PERFORMING ARTS



WARM UP – RAIN PLAN (BAND ROOM – OLD AUX GYM)



WARM UP – RAIN PLAN  
(AUX GYM – OLD PERFORMANCE GYM)



## MILLENNIUM HS PASSAGEWAY

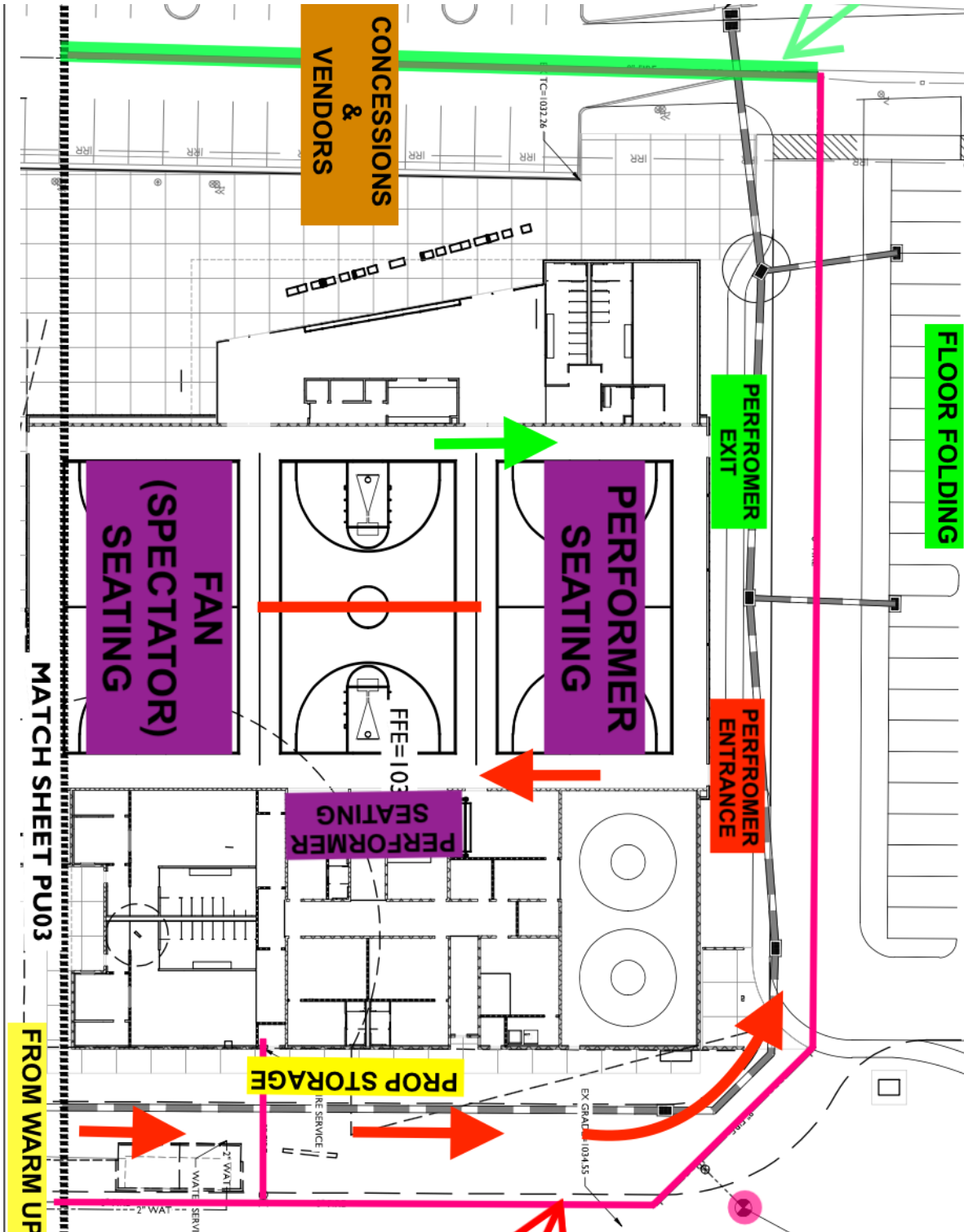



## MILLENNIUM HS CAMPUS MAP

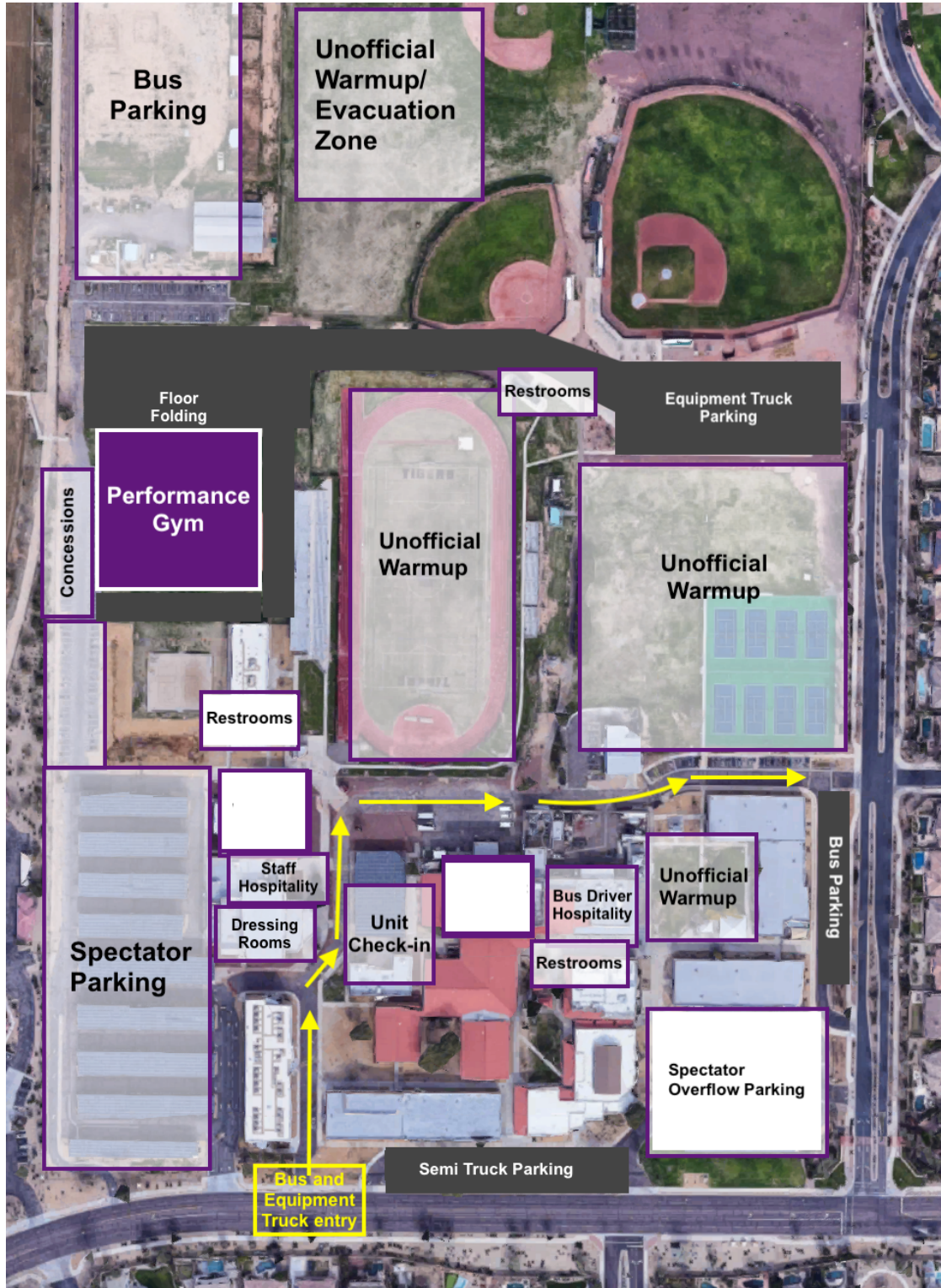



FLOOR FOLDING MAP

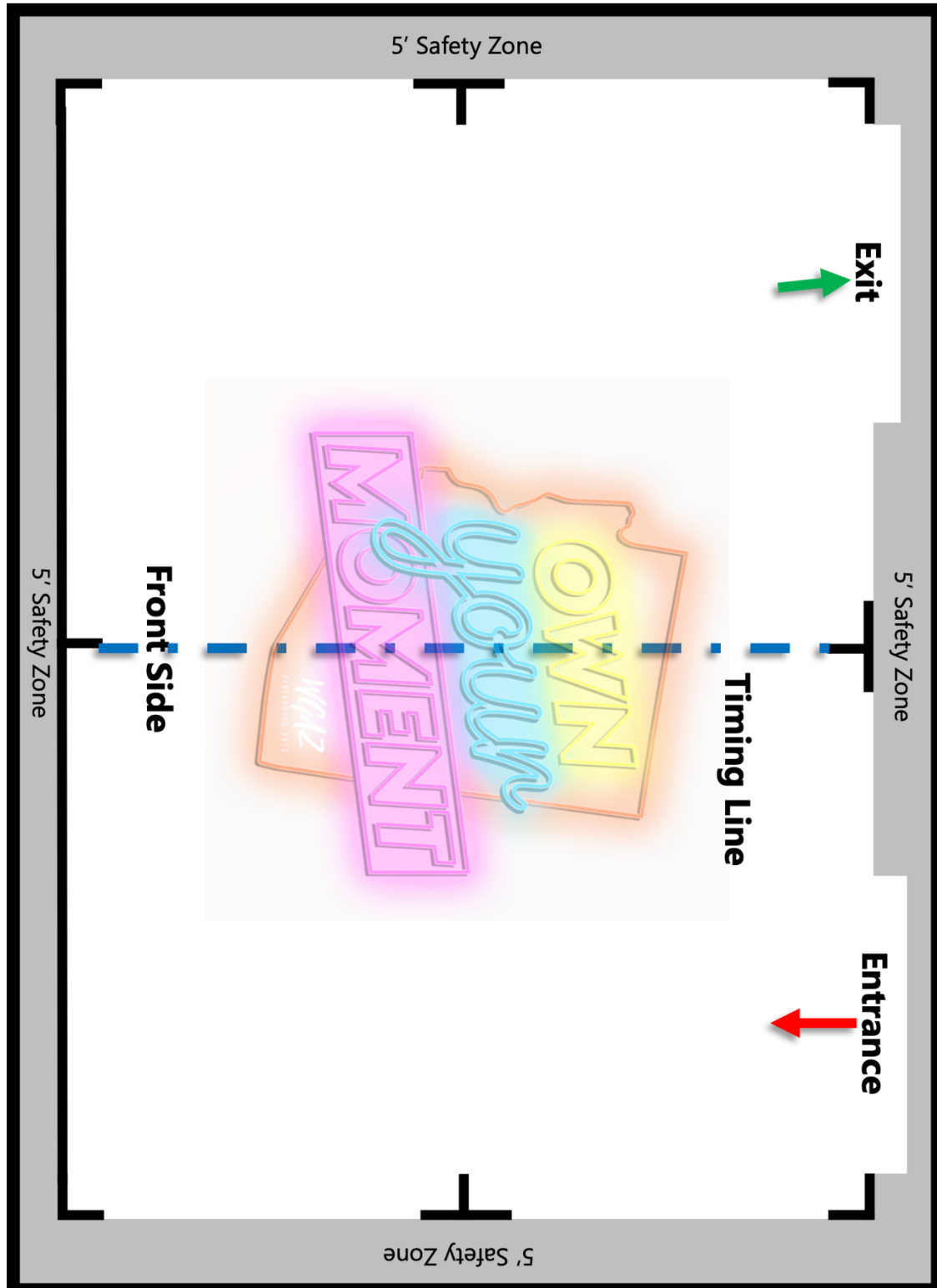



## STAFF VIEWING AREA

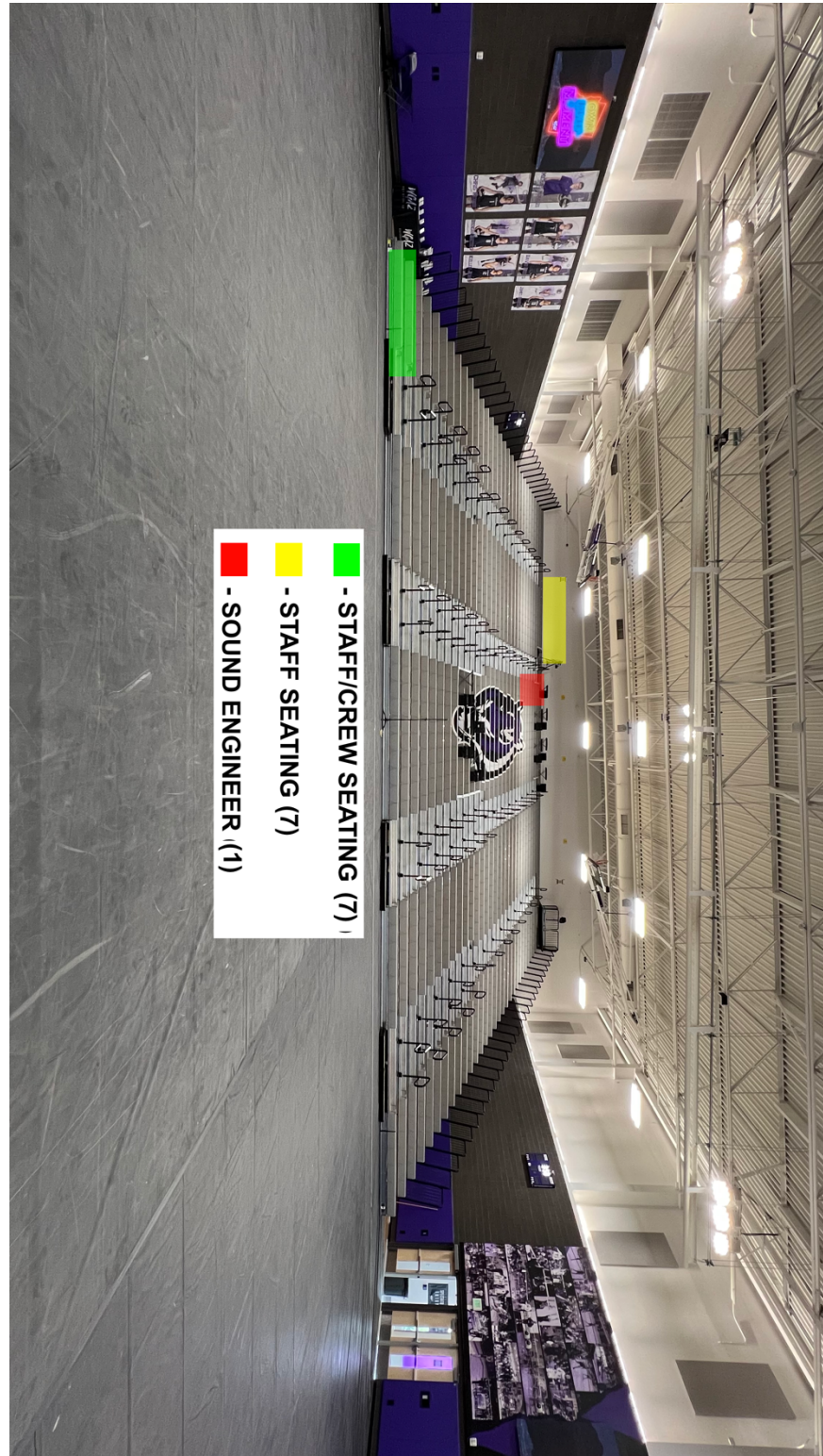

- STAFF/CREW SEATING (7)
- STAFF SEATING (7)
- SOUND ENGINEER (1)