

2018 Campo Verde Winter Invitational



Director, Instructor, or Unit Manager:

We would like to welcome you to the 2018 Campo Verde Winter Invitational on Saturday, March 24th, 2018. Please review the following information to ensure a smooth show throughout the day. For any show flow questions refer to the attached maps. Thank you for choosing to attend the Campo Verde Show and we hope you have a great show experience!

Address:

Campo Verde HS
3870 S. Quartz St.
Gilbert, AZ 85297

Admissions:

All units will be given 7 wristbands for your parent helpers and staff. ALL ADDITIONAL HELPERS MUST PURCHASE A WRISTBAND! Even just to help push equipment into the show.

\$8 Admission

\$6 Students and Seniors

Free admission for children 5 and under

Spectator Parking:

Spectator parking is located on the northeast side of campus next to the stadium.

Bus and Truck Parking:

All buses and equipment trucks must enter in the South West side of campus off of Germann Road. You will be directed to the west parking lot. If your unit members are traveling individually there will be parking spots available in the spectator parking lot on the east side of campus. Unfortunately, the west lot is too small to accommodate for staff and student parking. ***Please park vehicles in the east spectator lot.***

Practice Floors and Time Line:

Per WGAZ policy, units are not permitted to open performance floors in the parking lot. You may use a practice floor only and it must be clearly marked "practice". If you are using a practice floor in the lot, please be courteous of lot space for other units.

Check In & Video

There will be a station near the parking lot for unit check-in. A unit representative must check in and pick up a unit packet that will contain wristbands for both staff and performers. There are 7 staff wristbands in each packet. Additional staff wristbands can be purchased for \$7 each. There will be show sheets available but try to have your most recent information on the WGAZ website as that will be our source of your show sheet information. There is no videotaping or flash photography allowed. Your unit should have ONE video pass that you can use throughout the season.

Concessions:

Please let your students and parents know that there will be a full concession stand and vendors available for their lunch and/or dinner needs. No food or drink is allowed in the gym.

Director Hospitality:

The Director and Staff Hospitality room will be in the band room in building 3. We will have snacks and drinks available.

Have a great show!

Please contact us for any questions or emergencies regarding the show.

Matt Kozacek

Director of Bands

480-234-9158

matt.kozacek@gilbertschools.net

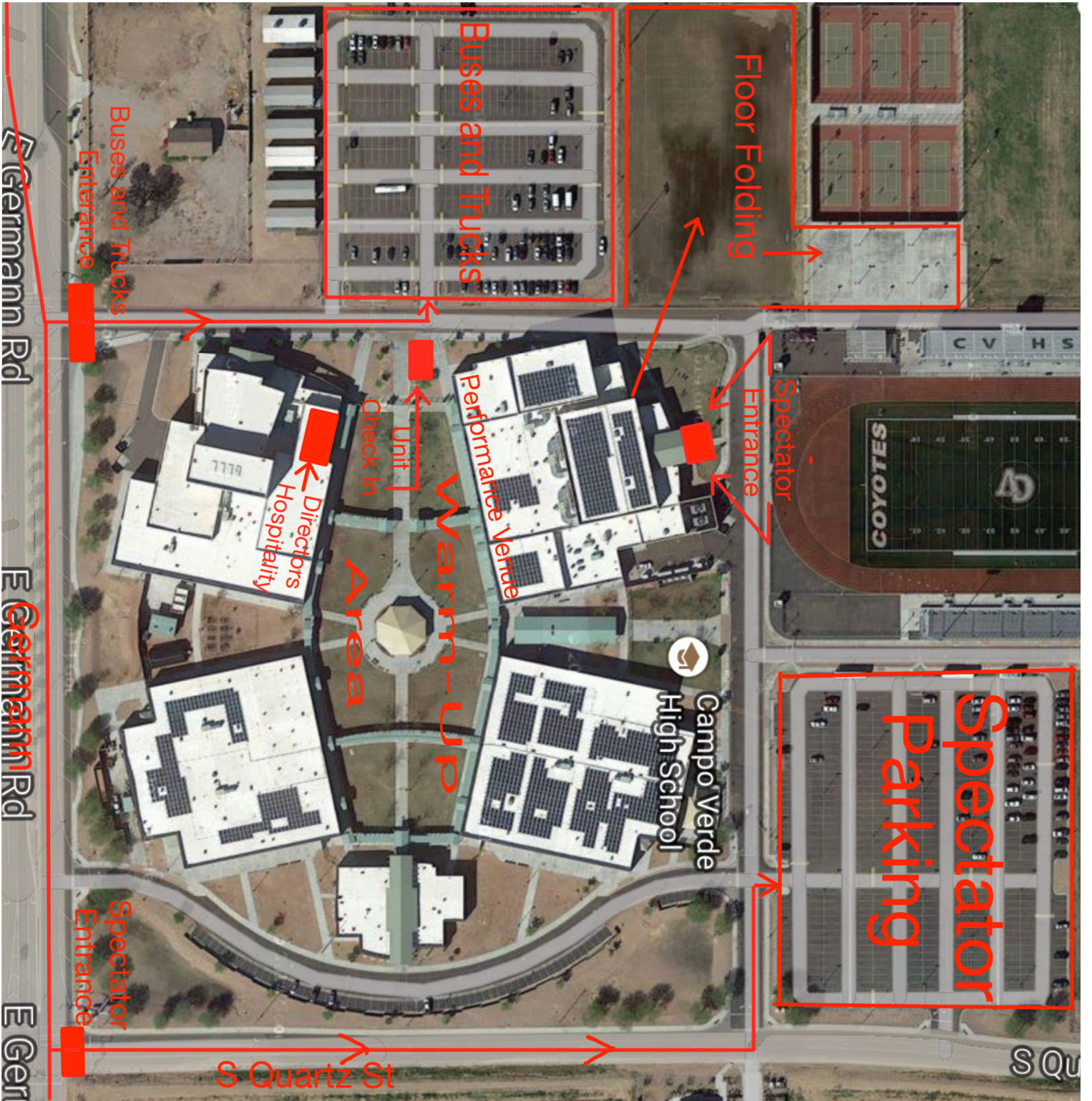

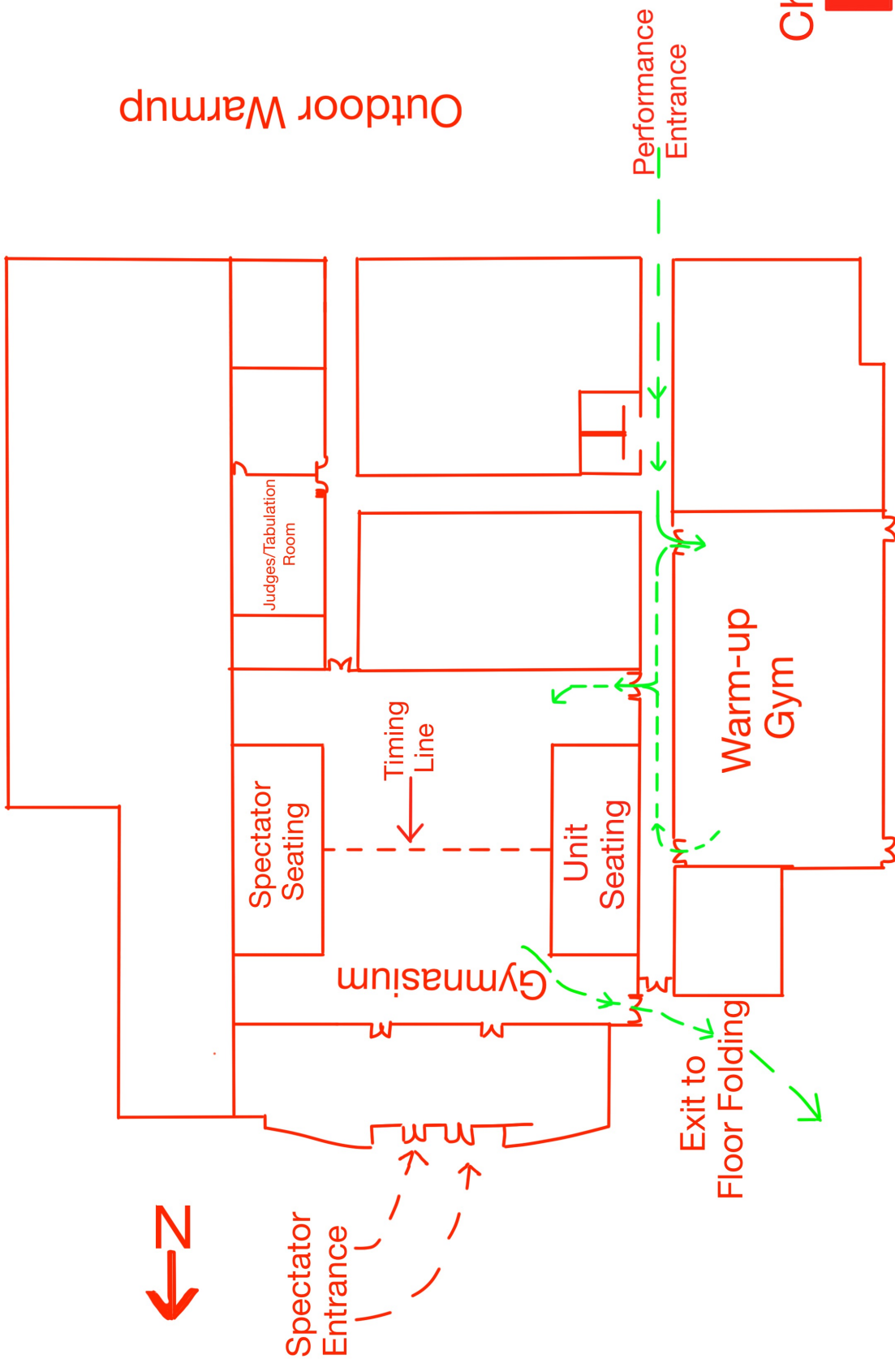

Outdoor Warmup

Check In