



## **Casa Grande UHS Contest Information Saturday, February 26, 2022**

### **LOCATION**

Casa Grande UHS  
2730 N. Trekell Rd  
Casa Grande, AZ 85122

### **FAN PARKING**

Fan parking is located off of Trekell Road under the covered parking.

### **BUS/TRAILER PARKING**

Please see the map for bus/truck entrance/parking on our campus. When you are driving on campus, please keep an eye out for the covered parking. We do not want any damage to these areas.

### **CHECK IN & VIDEO**

Directors will receive a packet with wristbands for all performers. Each unit will receive 7 staff wristbands in their packet. Any additional staff or volunteers will be required to pay an admission fee and preorder tickets by the Friday before the event. There is no video recording or flash photography allowed.

After you check-in (in the parking lot on the south/east side of the campus) you will find restrooms open for your students. Our check-in personnel and student guides will be happy to assist you. All our parent volunteers will be wearing bright yellow VOLUNTEER t-shirts.

Please do not hesitate to ask them if you have any questions.

### **CONCESSIONS**

We are serving a wide array of affordable food options for your staff and students. In the open area, outside the front of the gym, we are planning to have hamburger, or hotdog, baskets (includes a bag of chips, and a drink) for \$5.00. There will also be a (2) grilled steak taco plate for \$6.00

In addition, inside our cafeteria, we will offer typical concession items such as: Gatorade, sodas, candy, nachos, popcorn, etc. Prices range from \$0.50 - \$5.00.

*No food is allowed in the Gym.*



### **TICKET SALES:**

WGAZ is ready for the new indoor season and excited for all the events to come. To ensure students, staff, and fans are safe and can easily access events, we have partnered with GoFan to provide digital tickets and contactless payments. To buy tickets, visit our GoFan page. <https://gofan.co/app/school/AZ86318%E2%80%8B>

### **Please note:**

- Wristbands will only allow gym access for a specific block of performances
- Check standard schedule of the event to confirm which block to purchase tickets.
- Ticket purchases will be online or through a QR code only
- Show proof of tickets on GoFan App to receive a wristband
- Masks are highly encouraged at WGAZ events.
- Limited seats will be available

*WGAZ recommends all fans to arrive 30 minutes before units performance*

# WGAZ

PERFORMING ARTS



## **EMERGENCY CONTACT (DAY OF SHOW ONLY)**

Contest Administrator: Danielle Dorks-Gray 602.451.1141

Event Partner: Pasty Burruel 520.705.4249

## **JUDGE PANEL**

### **COLOR GUARD**

Equipment: Tim Hart

Movement: Julie Strange

General Effect: Laura Baker

General Effect: Joyce Loughrige

Design Analysis: Ryan Turner

### **PERCUSSION/WINDS JUDGES:**

Music: Bryan Hummel

Music Effect: Jim Williams

Visual: Juan Mateo

Visual Effect: Ryan Turner

### **EVENT STAFF**

Contest Administrator: Danielle Dorks-Gray

T&P: Sal Valencia Franco

Sound Engineer: Aaron Hudson

Tabulator: Ian Peterson

*Judge and Staff assignments and schedules subject to change*

## **COMPETITIONSUITE DETAILS**

ACCESSING YOUR GROUP - <https://help.competitionsuite.com/article/16-accessing-your-group>

ADDING YOUR STAFF - <https://help.competitionsuite.com/article/61-adding-staff-members>

ACCESSING COMMENTARY - <https://help.competitionsuite.com/article/17-accessing-commentary>

MUSIC UPLOADS - <https://help.competitionsuite.com/article/74-uploading-performance-music>

# ARIZONA'S #1 APPAREL PROVIDER FOR THE MARCHING ARTS



**WHERE WE CUSTOMIZE YOUR STYLE**

**SCREEN PRINTING AND EMBROIDERY**

**CUSTOM VINYL PROPS**

**BAND JACKETS**

**QUICK TURN  
AROUND TIME**

**SHOW SHIRTS**

**STAFF POLOS**

**FUNDRAISING  
OPPORTUNITIES**

**[www.MVPapparel.us](http://www.MVPapparel.us)**

**EMAIL**

**[Info@MVPapparel.us](mailto:Info@MVPapparel.us)**

**CALL**

**480-808-1MVP**



**SITE:**

Casa Grande Union High School  
2730 N Trekell Rd  
Casa Grande, AZ 85122

**DIMENSIONS:** 110' X 67'

**FRONT SIDE BLEACHER ROWS:** 14

**SEATING CAPACITY:** appx 800

**APPROXIMATE CELING HEIGHT:** appx 40 ft

There are no stairs to contend with in the competition area.

There are retractable hoops above the competition floor.

Units do not enter the competition area directly from outside.

There is electrical power available at the front and back sidelines.

Units exit the competition area through a cafeteria and hallway to the outdoors.

There is no indoor prop storage available before your performance.

There is a designated fold the floors area outside the exit after the performance.

There will be a black, appx 60'X90', vinyl tarp with covering the performance gym floor.

The distance from the warm up area to the competition area is less than 5 minute.

There are not separate areas for body and equipment.

**WARM UP AREAS**

See Map

Percussion/Winds – Outdoors

Color Guard – Aux Gym

# WGAZ

PERFORMING ARTS

PERFORMANCE GYM SPECTATOR VIEW:



PERFORMANCE GYM PERFORMER VIEW:



WARM UP A

East tennis courts – Warm-up A



WARM UP B

Tennis courts west – Warm-up B





## OVERFLOW WARM UP

Stadium – Warm-up C?





CASA GRANDE UHS PASSAGEWAY  
DOORWAYS ARE APPROX 76"

## Map of the Performance Space (Gym)

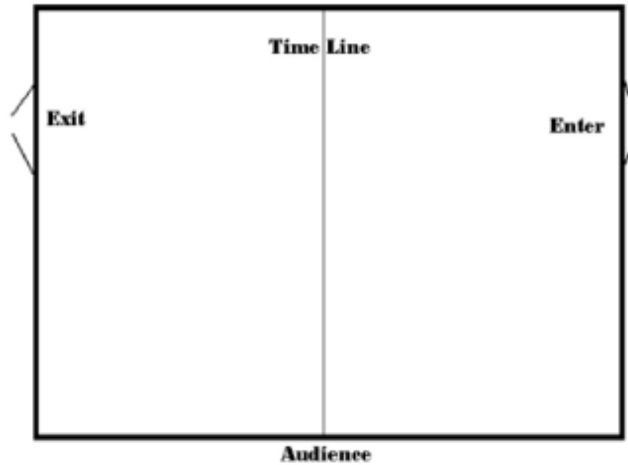

## Performance Path thru Campus

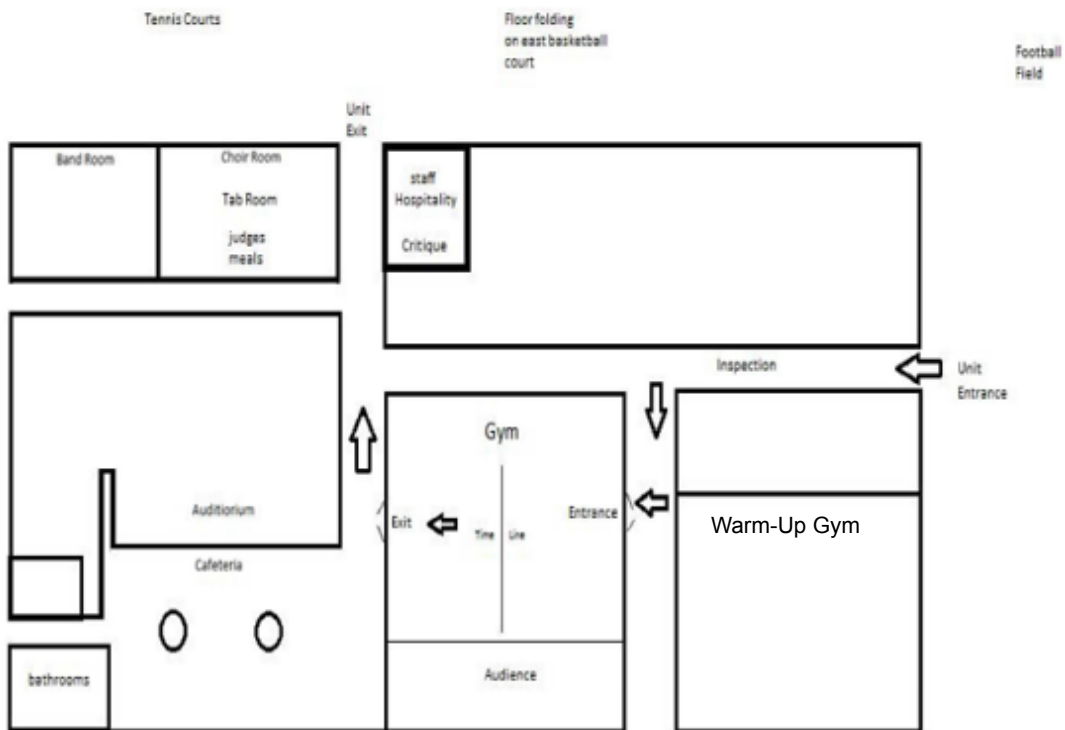

## CASA GRANDE UHS CAMPUS MAP

### Map of the Campus

